



Emergency Lighting and Signal Warning Lamps

A comprehensive range of products that meet the requirements of a modern Emergency Response Fleet.



Contents

Emergency Lighting and Signal Warning Lamps

LED Multi-flash Signal Lamps	154-155
LED Signal Warning Lamps	156-157
LED Beacons	158-159
LED Light Bars	160
Halogen Light Bars	161
Revolving Beacons KL 7000	162
Revolving Beacons KL 700/KL 710	163
Revolving Beacons KL Junior	164
Revolving Beacons KL Junior Plus/KL 8000	165
Revolving Beacons Rotoflex/Rotofix	166
Strobe Beacons Firebolt Plus/Pulsator 451	167
Beacons KL 30	168
Revolving Beacon Spare Parts	169

HELLA EMERGENCY AND SIGNAL WARNING LIGHTING

HELLA's range of Emergency Lighting and Signal Warning Lamps provide high levels of performance and reliability for situations where a powerful warning light is required to attract attention.



HELLA's revolving and warning lamps, either in LED, bulb or strobe technology, offer choices of signal colour, luminous intensities, flash patterns and supply voltages, providing a complete range to suit most applications and performance requirements.

Light Technology

HELLA rotating beacons offer robust design and superior light performance. The high gloss, vapour-coated parabolic reflector and halogen bulb form an efficient optical system, maximising the light performance. The rotating light pattern is well recognised as a highly effective warning signal in all conditions, even in bright sunlight.

The design of the internal airflow prevents the light dome and reflector from accumulating condensation providing full functional safety at all times, while maintenance-free bearings and drive belt technology ensures smooth operation. Instant activation is ensured from ambient temperatures ranging from -40°C to $+60^{\circ}\text{C}$.

LED High Intensity Emergency Lighting

High intensity LED signal warning lamps are specially designed for emergency services and specialist applications. Features include ultra long service life, reduced maintenance requirements, reliability and outstanding light performance.

The HELLA Multi-flash range of warning lamps have 10 programmable flash modes and can be synchronised to flash alternatively, as a sequenced running pattern or in unison.





Electromagnetic Compatibility (EMC)

Electromagnetic compatibility (EMC) is an increasingly relevant feature for Emergency and Signal Warning lighting.

As electronic devices become more common, so does the risk of unintended interference that can have adverse effects on other sensitive devices such as radios or communication equipment.

HELLA lighting products are designed and tested to reduce the possible risk of electromagnetic interference, both emissions as well as susceptibility, to limits defined in international standards.

As prescribed by New Zealand legislation, under circumstances, electronic products sold in New Zealand must be labelled with the C-tick  or RCM  marks. HELLA products are designed, tested and labelled to meet the requirements of this legislation



A cut away image showing the construction of the beacon and reflector.

Revolving Beacons

HELLA's revolving beacons are specified with a robust plastic housing. This material is lightweight and insulated.

Noise is effectively minimised in some lamps by utilising silver contacts and a drive belt system. Dual drive belts ensure the lamp remains fully operational even if one of the belts should fail.

HELLA revolving beacons feature corrosion resistant bulb holders. On some models bulbs can be replaced from the rear of the reflector, preventing damage to the highly polished and coated reflector.

HELLA's revolving lamps incorporate radio frequency (RF) suppression which reduces the potential for interference with on-board communication equipment.

Beacons and Optical Warning System Advantages:

- Intense light output - maximising warning light visibility and effectiveness.
- Independent bulb socket system - allows for simple, fast light source replacement without misalignment of the reflector.
- Economic product solution – low maintenance costs, minimal replacements required.

ELIVER THE ONLINE COMPARISON TOOL



Compare Beacons and Optical Warning Systems, Work Lamps, Auxiliary Head Lamps online.



Scan the QR Code for the Eliver home page. QR Code reader required.

www.hella.com/eliver

CAUTION: MOUNTING OF MAGNETIC BASE REVOLVING LAMPS

Due to environmental variances involved with vehicle acceleration and deceleration, fitment of warning lamps with a magnetic base cannot be recommended for use on moving vehicles



PERFORMANCE AND RELIABILITY ARE GUARANTEED

HELLA Emergency Lamps are tested to International Standards.

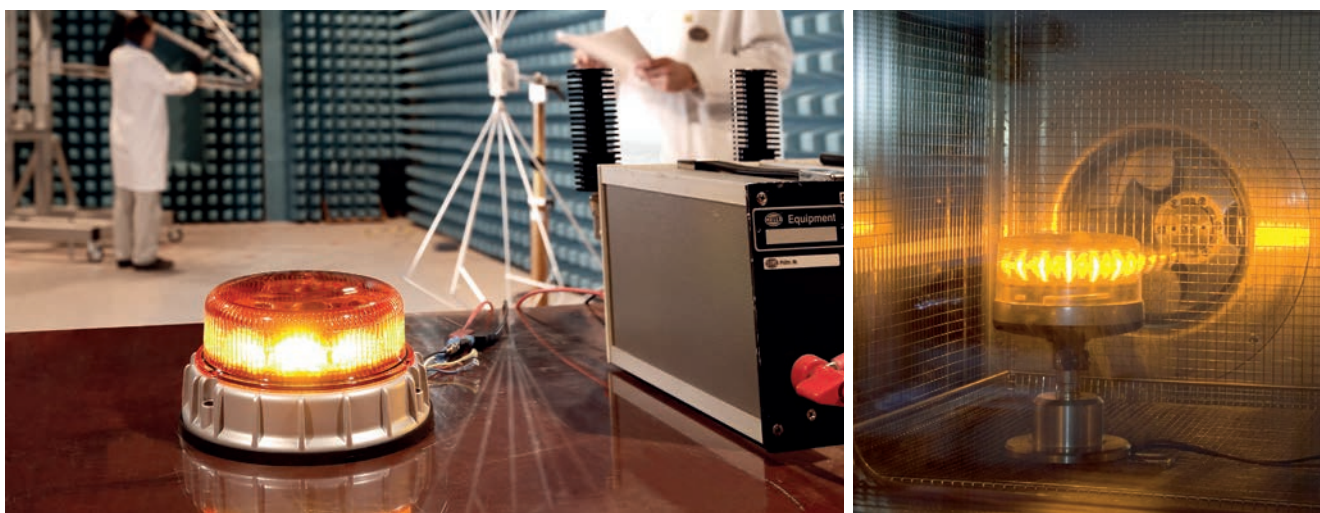

Vibration Test

This test simulates the behaviour of the products in harsh off-road conditions and verifies resistance to potholes, washboard road patterns and gravel roads.

The wide band random vibration test is used to test the mechanical endurance strength of the test specimen. The vibration frequency range extends from 10 to 1000 Hertz. In addition to vibration testing, products are subjected to a temperature overload of -40°C to +80°C.

Ingress Protection (IP ratings)

HELLA Emergency and Signal Warning Lighting contain precision electronic and mechanical components in order to achieve outstanding product performance. In order to protect these components and assure long term reliability HELLA products are designed and tested to meet international standards on ingress protection as per IEC 60529, DIN 40050-9 or ISO 20653.

Dust Test

Entry of dust can affect the optical and mechanical operation of a lamp, potentially compromising its performance and reliability. Accordingly HELLA products are designed and tested to ensure the risk of dust ingress is minimised or eliminated. Dust-resistant products are rated at IP 5(K) X, while dust-proof products are rated at IP 6(K) X.

Water Splash Test

HELLA products that fulfil the water splash test requirement have been subjected to environmental testing designed to simulate operating conditions representing normal weather conditions. When correctly installed heavy rain, direct splashes and water sprays up to 4 bar will have no adverse effects on the long term reliability and performance of the product. This level of protection is provided on HELLA products rated at IP X4K or above.

Temporary Immersion Test

HELLA products that fulfil the temporary immersion test requirement have been subjected to tests designed to simulate operating conditions that involve brief immersions in water such as off-road driving through a stream. This level of protection is provided on HELLA products rated at IP X7.

High-Pressure Cleaner Test

The ultimate in water ingress protection, HELLA products that fulfil the high-pressure cleaner test requirement are able to withstand water and steam jets of up to 80°C and 100 bar that may be encountered during commercial and industrial cleaning processes. This level of protection is provided on HELLA products rated at IP X9K.



Designed, tested and protected for guaranteed performance and reliability.

IP Ratings

How well protected is a product against environmental influences?
The IP protection class states how resistant the product is.
The classes are defined in DIN 40050-9. HELLA products
are designed for different degrees of protection:

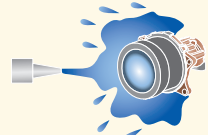
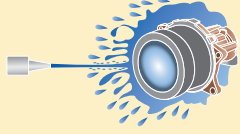
First Digit	PROTECTION AGAINST SOLID FOREIGN OBJECTS AND ACCESS TO HAZARDOUS PARTS		Second Digit	PROTECTION AGAINST LIQUIDS	
0	—	Non-protected	0	—	Non-protected
1	 50mm ↓ ● ↑	Protected against solid foreign objects of 50mm diameter and greater.	1		Protected against drops of water falling vertically.
2	 12.5mm ↓ ● ↑	Protected against solid foreign objects of 12.5mm diameter and greater.	2		Protected against drops of water falling vertically at up to 15° from the vertical.
3	 2.5mm ↓ ● ↑	Protected against solid foreign objects of 2.5mm diameter and greater.	3		Protected against spraying water falling vertically at up to 60° from the vertical.
4	 1.0mm ↓ ● ↑	Protected against solid foreign objects of 1.0mm diameter and greater.	4		Protected against splashing water from all directions.
5		Dust-protected.	4K		With higher pressure.
5K			5		Protected against jet of water from all directions.
6		Dust-sealed.	6		Protected against powerful water jets.
6K			6K		With higher pressure, specific for road vehicles.
			7		Protected against the effects of immersion. Protected against high-pressure cleaner, specific for road vehicles.
			8		Protected against prolonged effects of immersion under pressure to specified depth.
			9K		Protected against high-pressure cleaner, specific for road vehicles.



DuraLED® Multi-flash Signal Warning Lamp

Multivolt™ warning lamps for emergency vehicles. The HELLA multi-flash range of warning lamps have 10 programmable flash modes and can be synchronised to flash alternately or in unison.



P/N 95903711

P/N 95903761



P/N 95903781

P/N 95903791

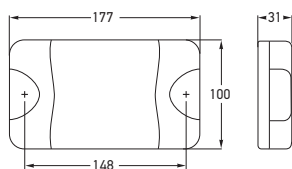

Part Number	95903701	RED
	95903711	AMBER
	95903761	BLUE
	95903781	GREEN
	95903791	WHITE

Mounting Two hole surface mount with mounting bushes supplied.

Voltage Multivolt™ for optimum brightness at input voltages from 9 to 33 volts.

Power Consumption 9W continuous (less in flashing modes).

Protection Reverse polarity and 5000 watt Transient Voltage Suppressor (TVS)
IP 6K6 (Protection against dust and high-pressure water jets)
IP 6K7 (Protection against dust and temporary water immersion)

Cable Length Pre-wired with 2.5m of sheathed multi-core cable.

Compliance SAE J845 Class 1 (Red and amber versions) EMC e4 03 1925

See page 66 for DuraLED® accessories.

HELLA MULTI-FLASH LAMP OPERATING MODES



Selectable Flash Patterns

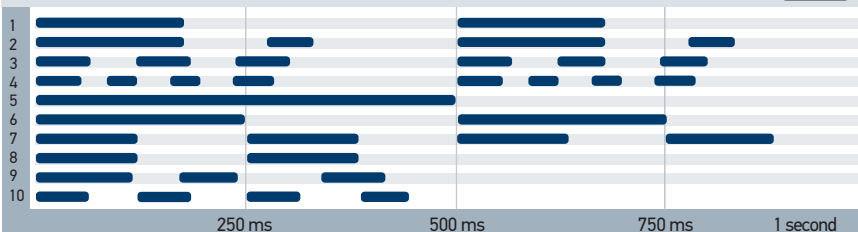

Flashing Options

Steady state	Lamp operates as a continuous ON signal
Independent flash	Lamp operates from an external flashing system
Flash state	Lamp operates in the flash mode preselected by the user
Blitz state	Lamp operates in a burst of quad flashes (pattern 4)

The blitz mode overrides the other operating modes and is triggered by switching the blue cable to negative (-).

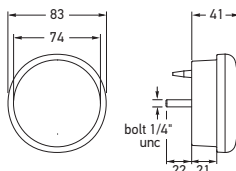

Part Number	95901140	RED
	95901145	AMBER
	95901160	BLUE
	95901165	GREEN
Mounting	Single bolt 1/4" stainless UNC thread. Nut and washer supplied.	
Voltage	Multivolt™ for optimum brightness at input voltages from 9 to 33 volts.	
Power Consumption	6W continuous (less in flashing modes).	
Protection	Reverse polarity and voltage spike protection. IP 6K7 (Protection against dust and temporary water immersion) IP 6K9K (Protection against dust and high-pressure/steam jet cleaning)	
Cable Length	Pre-wired with 2.5m of sheathed multi-core cable.	
Compliance	EMC 03 1681	

See page 69 for mounting accessories.

LED 83mm Round Multi-flash Signal Lamp

83mm diameter round LED signal lamps with single bolt mount for emergency vehicles. The HELLA multi-flash range of warning lamps have 10 programmable flash modes and can be synchronised to flash alternately or in unison.

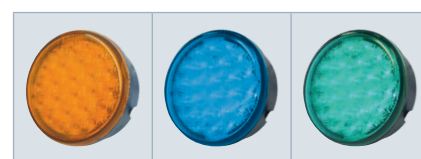

P/N 95901145 P/N 95901160 P/N 95901165

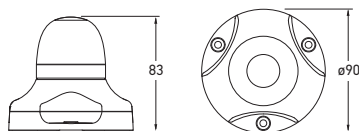

Part Number	98091100	WHITE
	98091120	GREEN
	98091140	RED
	98091160	AMBER
	98091170	BLUE
Mounting	Upright mounting with three point mount.	
Voltage	Multivolt™ for optimum brightness at input voltages from 9 to 33 volts.	
Power Consumption	Less than 5W (less in flashing modes).	
Protection	Reverse polarity and voltage spike protection. IP 67 (Protection against dust and temporary water immersion)	
Cable Length	Pre-wired with 2.5m of sheathed multi-core cable.	
Lens Material	Grilamid®	
Compliance	EMC  03 1679	
Lamps shown illuminated (right).		

LED 360° Multi-flash Signal Lamp

Multi-purpose LED 360° warning lamp with clear Grilamid® lens, available in four signal colours and white. The HELLA multi-flash range of warning lamps have 10 programmable flash modes and can be synchronised to flash alternately or in unison. Optic appears clear until illuminated.



P/N 98091120 P/N 98091140



P/N 98091160 P/N 98091170

EuroLED® Signal Warning Lamp - 24 Volt

Low profile signal warning LED lamp featuring Ultra Wide Visibility Optics for significantly improved side visibility.



P/N 95902181

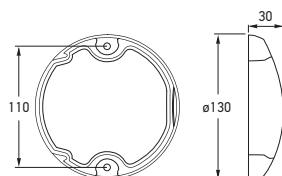

Part Number	95902081	RED
	95902181	AMBER
Mounting	Two hole surface mount with mounting bushes supplied.	
Voltage	20-28V	
Power Consumption	5W	
Protection	Reverse polarity and Transient Spike Circuit protection. IP 6K6 (Protection against dust and high-pressure water jets) IP 6K7 (Protection against dust and temporary water immersion)	
Cable Length	Pre-wired with 2.5m of sheathed multi-core cable.	
Compliance	EMC	e4 03 1140

This lamp requires an external flasher unit such as P/N 3040. See page 68 for EuroLED® accessories.

LED Wide Rim Strip Warning Lamp

Covert wide rim strip LED signal warning lamp available in red and blue colour variants. Optic appears clear until illuminated. Includes gasket, screws and screw caps.



P/N 95907370

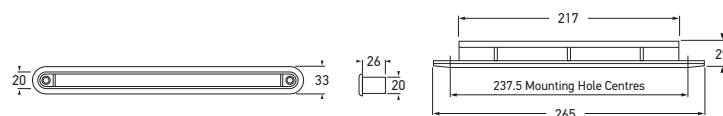

Part Number	12 VOLT	24 VOLT	
	95907360	95907365	BLUE
Part Number	95907370	95907375	RED
Mounting	Two hole recess mount. May be mounted horizontally or vertically.		
Power Consumption	2W		
Protection	Reverse polarity protection. IP 6K7 (Protection against dust and temporary water immersion) IP 6K9K (Protection against dust and high-pressure/steam jet cleaning)		
Cable Length	Pre-wired with 2.5m of multi-core cable.		

This lamp requires an external flasher unit such as P/N 3040. See page 70 for strip lamp accessories.

LED 360° Warning Lamp

Multi-purpose LED 360° warning lamps with Grilamid® lens available in four signal colours and white. Optics appear clear until illuminated.

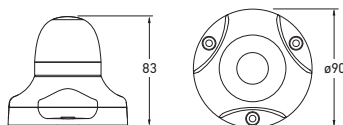

Part Number	98091004	WHITE
	98091024	GREEN
	98091044	RED
	98091064	AMBER
	98091074	BLUE
Mounting	Upright mounting with three point mount.	
Voltage	Multivolt™ for optimum brightness at input voltages from 9 to 33 volts.	
Power Consumption	5W	
Protection	Reverse polarity and voltage spike protection. IP 67 (Protection against dust and temporary water immersion)	
Cable Length	Pre-wired with 2.5m of sheathed multi-core cable.	
Lens Material	Grilamid®	
Compliance	EMC	e4 03 1679
See page 155 for multi-flash versions. This lamp requires an external flasher unit such as P/N 3040.		

EMERGENCY LIGHTING AND SIGNAL WARNING LAMPS

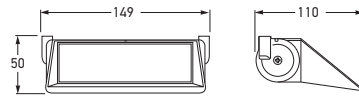

Part Number	95913610	AMBER
Mounting	Dash mount.	
Voltage	12V	
Power Consumption	3W	
Cable Length	Pre-wired with 2.5m of multi-core cable.	
This lamp requires an external flasher unit such as P/N 3040.		

LED Dash Mount Signal Lamp
- 12 Volt

Inconspicuous LED warning lamp with an unobtrusive and aesthetic design allowing for permanent fitment, making it an ideal supplement to revolving or strobe lamps attached to the vehicle roof. Optic appears clear until illuminated in amber signal colour.

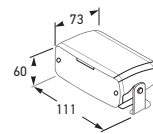

Part Number	329000A	AMBER
	329000R	RED
Mounting	Mounting bracket or suction caps (included).	
Voltage	12V	
Power Consumption	19W	
Cable Length	Pre-wired with 2.7m of cable with switchable power plug.	

LED Viper™ S2 Signal Lamp
- 12 Volt

Viper™ S2 advances auxiliary internal warning to a higher plateau with superior light output, easy-to-select flash patterns and simple pattern synchronization. The superior warning capability of Solaris™ reflector technology provides a bold array of light and impressive off-axis reflection. Phenomenal light output, versatile mounting options and simplistic product functionality make the Viper™ S2 product stand out in the warning light industry.

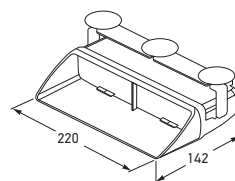

Part Number	329000AA	AMBER
	329000RR	RED
Mounting	Mounting bracket or suction caps (included).	
Voltage	12V	
Power Consumption	28W	
Cable Length	Pre-wired with 2.7m of cable with switchable power plug.	

LED Viper™ S2 Signal Lamp
- 12 Volt

Viper™ S2 advances auxiliary internal warning to a higher plateau with superior light output, easy-to-select flash patterns and simple pattern synchronization. The superior warning capability of Solaris™ reflector technology provides a bold array of light and impressive off-axis reflection. Phenomenal light output, versatile mounting options and simplistic product functionality make the Viper™ S2 product stand out in the warning light industry.



Push button pattern selection makes selecting one of over 20 flash patterns simple.



Snap on guards attach or detach without requiring the use of hand tools and provide flash protection inside the vehicle.



The power plug option allows for instant installation and features an on/off switch for fast activation.

LED UltraRAY® Warning Beacon

UltraRAY® LED beacons offer multiple, user-selectable flash patterns that suit a large variety of applications. Additional user selectable features include a battery saver mode to alert users if the equipment power supply drops below normal operating voltage levels to conserve power, as well as a daylight sensing that can automatically adjust the intensity of the beacon to ambient light levels.

A reverse gear circuit allows the flash pattern to be changed to alert staff of the travel direction of the equipment. UltraRAY® beacons are extremely robust, tolerant to severe vibration levels and very compact in design.

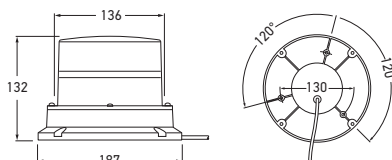

Part Number	27091001	AMBER
Voltage	Multivolt™ 12-30V	
Power Consumption	20W max.	
Protection	IP 6K5K (Protection against dust and powerful water jets at increased pressure)	
Cable Length	Pre-wired with 200mm of cable.	
Compliance	SAE J845 Class 1	



LED UltraRAY® R Rotating Beacon

UltraRAY® R LED beacons feature user selectable 'rotating' or quad flash patterns. They are extremely robust, tolerant to severe vibration levels and very compact in design. UltraRAY® R LED warning beacons are maintenance free with no moving parts or fragile globes.

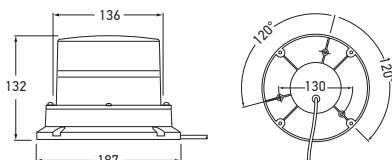

Part Number	27091071	AMBER
	27091091 (High output)	
Voltage	Multivolt™ 12-30V	
Power Consumption	20W max.	
Protection	IP 6K5K (Protection against dust and powerful water jets at increased pressure)	
Cable Length	Pre-wired with 200mm of cable.	
Compliance	SAE J845 Class 1	



EMERGENCY LIGHTING AND SIGNAL WARNING LAMPS

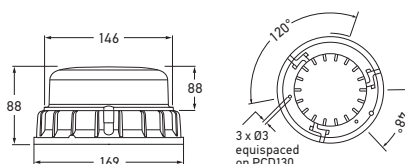

Part Number	1614			AMBER
	1614-MAG (Magnetic mount)			
	1616			RED
Mounting	Fixed or magnetic mounting on horizontal surfaces.			
Voltage	Multivolt™ for optimum brightness at input voltage from 9 to 33 volts.			
Power Consumption	30W max.			
Protection	Reverse polarity and Transient Spike Circuit protection. IP 6K7 (Protection against dust and temporary water immersion)			
Flash Rate	Simulated rotation 120rpm (2.00Hz)			
Compliance	ECE R65 TA2	ECE R65 TR2	SAE J 845 Class 1	CISPR25 Class 5

K-LED 2 Beacon

K-LED low profile beacons are the ideal choice wherever beacons risk interference with radio communications. Featuring 20 high power LEDs providing high light output for best visibility. An automatic day/night sensor adjusts brightness to avoid glare discomfort at night. 14 different flashing and 2 rotating patterns.

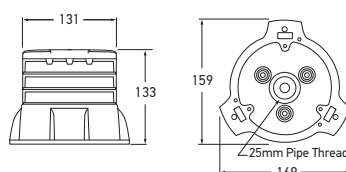

Part Number	2RL 011 585-001	AMBER
Mounting	Fixed on horizontal surfaces.	
Voltage	Multivolt™ 9-33V	
Power Consumption	33W max. average	
Temperature Range	-20° to +50°C	
Protection	Overheat, reverse polarity and short circuit protection. Shock resistant to 200G. IP 6K9K (Protection against dust and high-pressure/steam jet cleaning)	
Flash Rate	Simulated rotation 133rpm (2.22Hz)	
Compliance	CISPR25 Class 3 UL94HB	

DuraRAY3® Beacon

DuraRAY3® beacons are designed for mining and construction applications where the cost of equipment downtime is large and safety is paramount.



Caution: Mounting of Magnetic Base Revolving Lamps

Due to HELLA being unable to control the condition of the mounting surface or the potential forces that may occur during deceleration, fitment of warning lamps with a magnetic base cannot be recommended for use on moving vehicles.

LED Highlighter™ Mini Light Bars

The Highlighter™ LED combines the high performance ROC™ (Reliable On-board Circuity) with the high efficiency Solaris™ reflector design. The innovative reflector design offers uniform 360° light distribution, which means no dark spots or shadows.

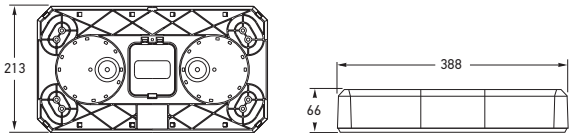
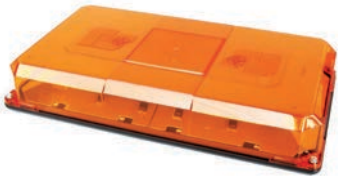

P/N 454218/454217

Part Number	12 VOLT	24 VOLT	AMBER
	454201A	454201A-24V	
	454205A (Economy)		
	454201AMAG (Magnetic base)		
	454201R	454201R-24V	RED
	454201B		BLUE
Flash Rate	20 selectable flash patterns.		
Current Draw	12V - 5.0A max. 24V - 3.0A max.		
Spare Parts	454217	Mount riser 52mm	
	454218	Mount flat 12mm	
	452341	Magnetic mounting kit	
	9.454201.07	Highlighter base	
	9.454201.02	Amber lens	
	9.454201.03	Blue lens	
	9.454201.04	Red lens	
	9.454201.05	Clear lens	
Compliance	SAE J845 Class 1		

HELLA does not recommend the magnetic base version for use on a moving vehicle (see page 159).



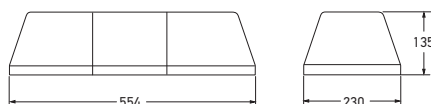

Part Number	12 VOLT	24 VOLT	
	7415111	7211908	AMBER
	7211702	7211908-R	RED

Flash Rate 190 flashes per minute.

Bulbs to Suit	12V	2 x C1255
	24V	2 x C2470

Spare Parts

7210897	Magnetic mount kit
7210989	Lens retainer/plug kit
7411010	Motor/reflector assembly 12V
Z8559A002B	Worm gear - replacement
7439234	Motor/reflector assembly 24V

Compliance SAE J845 Class 1

Turbo Beam 56cm (22") Light Bar

Turbo beams are built from very highly reliable components to maximise their effectiveness in extreme conditions. They also feature impact-resistant polycarbonate domes and aluminium alloy extrusions to increase service life. In addition, the Turbo Beam's powerful rotators contain parabolic reflectors, providing exceptional performance and reliability.



P/N 7210989

P/N 7210897

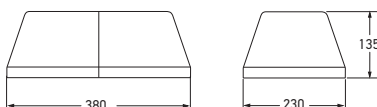

Part Number	12 VOLT	24 VOLT	
	7415010	7211900	AMBER
	7211700	7211900-R	RED

Flash Rate 190 flashes per minute.

Bulbs to Suit	12V	2 x C1255
	24V	2 x C2470

Spare Parts

7210897	Magnetic mount kit
7210989	Lens retainer/plug kit
7411010	Motor/reflector assembly 12V
Z8559A002B	Worm gear - replacement
7439234	Motor/reflector assembly 24V

Compliance SAE J845 Class 1

Turbo Beam 38cm (15") Light Bar

Turbo beams are built from very highly reliable components to maximise their effectiveness in extreme conditions. They also feature impact-resistant polycarbonate domes and aluminium alloy extrusions to increase service life. In addition, the Turbo Beam's powerful rotators contain parabolic reflectors, providing exceptional performance and reliability.



P/N 7415010

LENSES FOR TURBO BEAM LIGHT BARS

Lens	Left Hand	Centre	Right Hand
Amber	P/N 7411187	P/N 7411177	P/N 7411167
Red	P/N 7411189	P/N 7411179	P/N 7411169
Blue	P/N 7411186	P/N 7411176	P/N 7411166

Revolving Beacon KL 7000

KL 7000 high performance revolving beacon with light values well above the minimum requirements. All KL 7000 beacons can be operated on 12 or 24V by changing the bulb. The halogen bulb is replaced from the rear of the reflector eliminating the need to touch the highly polished reflector surface. A twin belt drive ensures a smooth and quiet operation.

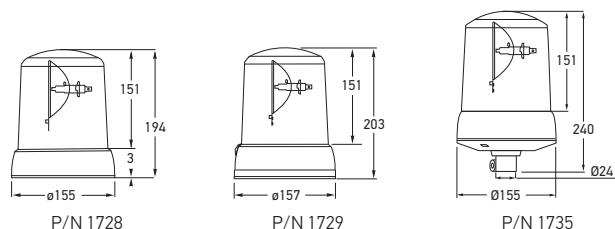

Part Number	12 VOLT		24 VOLT	
	1728		1728-24V	AMBER
	1727		1727-24V	RED
	1726		1726-24V	BLUE



Part Number	12/24 VOLT		
	1729 (Magnetic mount)		AMBER
	1735 (Flexibase mount)		
Current Draw	12V 24V	5.5A 3.5A	
Power Consumption	12V - 55W 24V - 70W		
Rotation	160rpm		
RF Suppression	Conducted Class 5 (CISPR25).		
Protection	IP 5K4K (Protection against dust and water splashing with increased pressure) IP X9K (Protection against high-pressure/steam jet cleaning)		
Bulbs to Suit	12V 24V	C1255 C2470	
Spare Parts	9.1726.01 Blue lens 9.1727.01 Red lens 9.1728.01 Amber lens 9.1737.91 Two drive belts 9.1726.23 Reflector assembly 9.1726.52 Motor assembly 12/24V 8007 Connecting piece 8007RA Connecting piece - right angle mount 8007FM Connecting piece - flat mount 8008 Connecting piece - threaded		
Compliance	R65/00	(E) 1241	e1 03 1740

HELLA does not recommend the magnetic base version for use on a moving vehicle (see page 159).
See page 169 for spare part images.



P/N 8007

P/N 8007FM

P/N 8007RA

P/N 8008



P/N 1729

P/N 1735

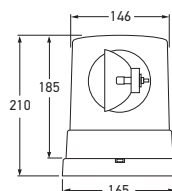
EMERGENCY LIGHTING AND SIGNAL WARNING LAMPS

Part Number	12 VOLT		24 VOLT	
			1720	BLUE
			1721	RED
	1724			1722
Power Consumption	12V - 55W 24V - 70W			
Rotation	160rpm			
RF Suppression	VDE 0879, Class 3, FM 5.			
Bulbs to Suit	12V 24V	C1255 C2470		
Protection	IP 5K4K (Protection against dust and water splashing with increased pressure) IP X9K (Protection against high-pressure/steam jet cleaning)			
Spare Parts	1653 Magnetic mounting kit 9.1717.01 Blue lens 9.1718.01 Red lens 9.1719.01 Amber lens (no optic lens) 9.1724.01 Amber lens 9.1723.01 Green lens 9.1725.02 Purple lens (Heavy haulage) 9.1717.54 Motor 12V 9.1720.54 Motor 24V 9.1737.91 Two drive belts 9.1717.23 Reflector base assembly			
Compliance	R65/00	E2 88072		
HELLA does not recommend the magnetic base version for use on a moving vehicle (see page 159). See page 169 for spare part images.				

Revolving Beacon KL 700

KL 700 high performance revolving beacon. The halogen bulb is replaced from the rear of the reflector eliminating the need to touch the highly polished reflector surface. Twin belt drive ensures a smooth and quiet operation.



P/N 1653

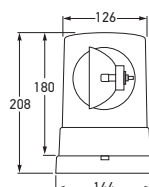

Part Number	12 VOLT		24 VOLT	
	1702		1705	AMBER
Power Consumption	12V - 55W 24V - 70W			
Rotation	160 +/- 30rpm			
RF Suppression	VDE 0879, Class 3, FM 5.			
Bulbs to Suit	12V 24V	C1255 C2470		
Protection	IP 5K4K (Protection against dust and water splashing with increased pressure) IP X9K (Protection against high-pressure/steam jet cleaning)			
Spare Parts	9.1709.01 Red lens 9.1708.01 Blue lens 9.1713.01 Amber lens 9.1717.54 Motor 12V 9.1720.54 Motor 24V 9.1737.91 Two drive belts 9.1717.23 Reflector base assembly 9.1717.52 Motor/reflector assembly 12V 9.1720.52 Motor/reflector assembly 24V			
Compliance	R65/00	E4 6506	E4 03 2183	
See page 169 for spare part images.				

Revolving Beacon KL 710

KL 710 high performance revolving beacon. The halogen bulb is replaced from the rear of the reflector eliminating the need to touch the highly polished reflector surface. Twin belt drive ensures a smooth and quiet operation.



Revolving Beacon KL Junior - Amber

Economy revolving beacon with gear drive and fixed halogen bulb.

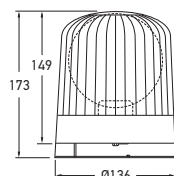

Part Number	71724	12 VOLT
	71722	24 VOLT
	71723 (Bulb/s not included)	12/24 VOLT
Mounting	Three point mount. Horizontal mount.	
Power Consumption	12V - 55W 24V - 70W	
Bulbs to Suit	12V 24V	C1255 C2470
Protection	IP 5K4K (Protection against dust and water splashing with increased pressure) IP X9K (Protection against high-pressure/steam jet cleaning)	
Spare Part	9.71722.01	Amber lens
Compliance	R65/00	(E) 6514 [e] 03 2182

Revolving Beacon KL Junior, Magnetic Mount - Amber

Revolving beacon complete with magnetic base for quick and secure attachment to vehicle roof. Features a spiral cable and power socket.

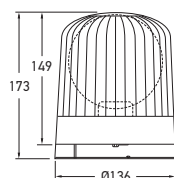

Part Number	71725 (Bulb/s not included)	12/24 VOLT
Rotation	160rpm	
Bulbs to Suit	12V 24V	C1255 C2470
Protection	IP 5K4K (Protection against dust and water splashing with increased pressure) IP X9K (Protection against high-pressure/steam jet cleaning)	
Spare Part	9.71722.01	Amber lens
Compliance	R65/00	(E) 6514 [e] 03 2182
HELLA does not recommend the magnetic base version for use on a moving vehicle (see page 159).		

Revolving Beacon KL Junior, Flexible Pipe Mount - Amber

Revolving beacon with flexible housing base with a spring action allowing beacon to bend on impact. The polycarbonate lens is particularly resistant to impact damage. The base incorporates a spigot tube mount.

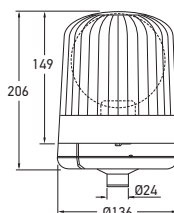

Part Number	71726 (Bulb/s not included)	12/24 VOLT
Mounting	Must be used in conjunction with connecting piece P/N 8007, 8007FM, 8007RA or 8008.	
Rotation	160rpm	
Bulbs to Suit	12V 24V	C1255 C2470
Protection	IP 5K4K (Protection against dust and water splashing with increased pressure) IP X9K (Protection against high-pressure/steam jet cleaning)	
Spare Parts	9.71722.01 8007 8007FM 8007RA 8008	Amber lens Connecting piece Connecting piece - flat mount Connecting piece - right angle mount Connecting piece - threaded
Compliance	R65/00	(E) 6514 [e] 03 2182

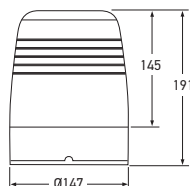

Part Number	1797	12 VOLT
	1797-24V	24 VOLT
	1797-MAG (12 and 24V bulbs included)	12/24 VOLT
Power Consumption	12V - 55W 24V - 70W	
Rotation	180rpm	
RF Suppression	Conducted Class 3 (CISPR 25).	
Bulbs to Suit	12V 24V	C1255 C2470
Protection	IP 5K4K (Protection against dust and water splashing with increased pressure) IP X9K (Protection against high-pressure/steam jet cleaning)	
Spare Parts	9.1797.01 9.1797.91	Amber acrylic lens Drive belt
Compliance	R65/00	(E) 1419 [e] 03 3954
HELLA does not recommend the magnetic base version for use on a moving vehicle (see page 159). See page 169 for spare part images.		

Revolving Beacon KL Junior Plus - Amber

KL Junior Plus revolving beacon offers a belt drive, which enhances reliability, bulb life and lowers noise output. Light output has been improved with the halogen bulb being located in the reflector.



P/N 1797-MAG

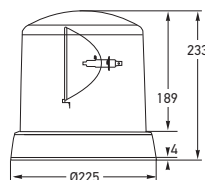

Part Number	1794	BLUE
	1795	RED
	1796	AMBER
Power Consumption	12V - 55W 24V - 70W	
Rotation	160rpm	
RF Suppression	Conducted Class 5 (CISPR 25).	
Bulbs to Suit	12V 24V	C1255 C2470
Protection	IP 5K4K (Protection against dust and water splashing with increased pressure) IP X9K (Protection against high-pressure/steam jet cleaning)	
Spare Parts	9.1794.01 9.1795.01 9.1796.01 9.1737.91 9.1794.23 9.1726.52	Blue lens Red lens Amber lens Two drive belts Reflector assembly Motor assembly 12/24V
Compliance	R65/00	(E) 1243 [e] 03 1740
See page 169 for spare part images.		

Revolving Beacon KL 8000 - 12/24 Volt

KL 8000 revolving beacon developed for large and heavy commercial vehicles. Particularly high light values guarantee utmost warning effectiveness and safety. Maximum smooth running thanks to the maintenance-free drive bearings and twin-belt technology.



Rotoflex Revolving Beacon - Amber

Rotoflex revolving beacon with polycarbonate lens and flexible rubber base.

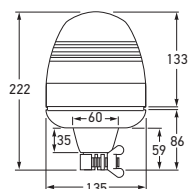

Part Number	1730		12 VOLT
	1731		24 VOLT
Mounting	Tubular base incorporates connection plug. Must be used in conjunction with connecting piece P/N 8007, 8007FM, 8007RA or 8008.		
Power Consumption	12V - 55W 24V - 70W		
Rotation	160rpm		
RF Suppression	Conducted Class 5 (CISPR 25).		
Bulbs to Suit	12V 24V	C1255 C2470	
Protection	IP 5K4K (Protection against dust and water splashing with increased pressure) IP X9K (Protection against high-pressure/steam jet cleaning)		
Spare Parts	9.1730.01 9.1732.52 9.1732.54 9.1730.23 8007 8007FM 8007RA 8008	Amber polycarbonate lens Motor 12V Motor 24V Reflector for Rotoflex Connecting piece Connecting piece - flat mount Connecting piece - right angle mount Connecting piece - threaded	
Compliance	R65/00	(E) 6509	e1 03 2181

See page 169 for spare part images.



P/N 8007

P/N 8007FM



P/N 8007RA

P/N 8008

Rotofix Revolving Beacon - Amber

Rotofix revolving beacon with polycarbonate lens and rubber base.

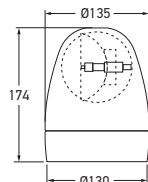

Part Number	12 VOLT	24 VOLT	
	1732	1732-24V	
	1733	1733-24V	MAGNETIC MOUNT
Mounting	Fixed base or with magnetic attachment.		
Power Consumption	12V - 55W 24V - 70W		
Rotation	160 +/- 30rpm		
RF Suppression	Conducted Class 5 (CISPR 25).		
Bulbs to Suit	12V 24V	C1255 C2470	
Protection	IP 5K4K (Protection against dust and water splashing with increased pressure) IP X9K (Protection against high-pressure/steam jet cleaning)		
Spare Parts	9.1730.01 9.1732.52 9.1732.54 9.1732.23	Amber polycarbonate lens Motor 12V Motor 24V Reflector for Rotofix	
Compliance	R65/00	(E) 6509	e1 03 2181



P/N 1733

HELLA does not recommend the magnetic base version for use on a moving vehicle (see page 159).
See page 169 for spare part images.

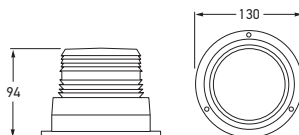

Part Number	1655	BLUE
	1656	RED
	1657	AMBER
	1663	GREEN
Voltage	Multivolt™ 12-72V	
Current Draw	0.24 - 0.04A	
Power Consumption	3 Watts, 2 Joules	
Flash Rate	60 +/- 10 per minute	
Protection	IP 55 (Protection against dust and water jets)	
Bulb to Suit	XN000	Strobe tube (see page 335)
Spare Parts	8027	Magnetic mounting kit
	9.1655.01	Blue lens
	9.1656.01	Red lens
	9.1657.01	Amber lens
	9.1655.03	Multi-voltage power supply, 12-72V
Compliance	SAE J1318 Class 3	

HELLA does not recommend the magnetic base version for use on a moving vehicle (see page 159).

Firebolt Plus Strobe Beacon -12-72 Volts

The Firebolt Plus strobe features a 2 joule power supply that works from 12 to 72V. Modular construction incorporates a powerful replaceable strobe tube and vibration resistant circuit board. The unit also features a tough impact-resistant polycarbonate lens and base. Applications include fork-lift, electric vehicles, industrial trucks and equipment. Supplied with enclosed base and all necessary mounting hardware (mounts with three bolts).



P/N 8027 (extendable to two metres).

P/N XN000

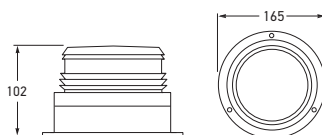

Part Number	1643	BLUE
	1644	RED
	1645	AMBER
Voltage	Multivolt™ 12-48V	
Current Draw	0.9 - 0.25A	
Power Consumption	11 Watts, 8 Joules	
Flash Rate	80 +/- 10 per minute, double flash.	
Protection	IP 55 (Protection against dust and water jets)	
Bulb to Suit	XN451	Strobe tube (see page 335)
Spare Parts	8028	Magnetic mounting kit
	9.1643.01	Blue lens
	9.1644.01	Red lens
	9.1645.01	Amber lens
	9.1643.03	Multi-voltage power supply, 12-48V
Compliance	SAE J1318 Class 2	

HELLA does not recommend the magnetic base version for use on a moving vehicle (see page 159).

Pulsator 451 Strobe Beacon - 12-48 Volts

The Pulsator 451 low profile, 12 to 48V strobe is ideal for applications that require shock-resistant mounting, water-resistant performance and easy maintenance. The unit is reverse polarity protected with an isolated earth that enables both negative and positive ground installations.



P/N 8028 (extendable to two metres).

P/N XN451

Flashing Beacon - 12 Volt

Fresnel lens. Flasher unit P/N 3008 included.

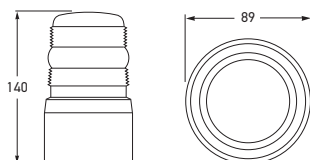

Part Number	1688	RED
	1689	AMBER
Mounting	Three holes for fixing screws.	
Bulb to Suit	U1245	
Spare Parts	1.6502.012 1.6502.01 1.6502.013 1.6502.014 3008	Red lens Amber lens Green lens Blue lens 12V Flasher unit

Flashing Beacon Magnetic Mount - 12 Volt

Fresnel lens. Flasher unit P/N 3008, 3m cable and lighter plug included.

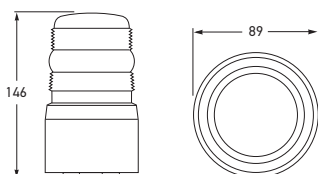

Part Number	1690	RED
	1691	AMBER
Mounting	Magnetic base.	
Bulb to Suit	U1245	
Spare Parts	1.6502.012 1.6502.01 1.6502.013 1.6502.014 3008	Red lens Amber lens Green lens Blue lens 12V Flasher unit

HELLA does not recommend the magnetic base version for use on a moving vehicle (see page 159).

Beacon - 12 Volt

Fresnel lens. Flasher unit not included.

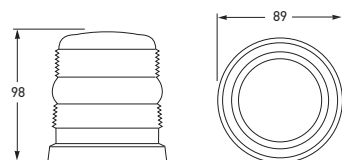

Part Number	1692	RED
	1694	BLUE
	1696	AMBER
Mounting	Three holes for fixing screws.	
Bulb to Suit	12V	U1245
Spare Parts	1.6502.012 1.6502.01 1.6502.013 1.6502.014	Red lens Amber lens Green lens Blue lens

EMERGENCY LIGHTING AND SIGNAL WARNING LAMPS

KL 7000 ACCESSORIES		
Part Number	9.1726.23	REFLECTOR ASSEMBLY
	9.1726.52	MOTOR ASSEMBLY 12/24V
	9.1737.91	TWO DRIVE BELTS

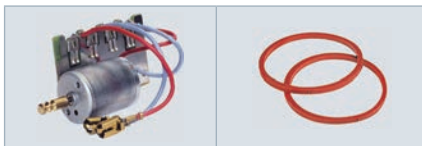

P/N 9.1726.52

P/N 9.1737.91



P/N 9.1726.23

KL 700 AND KL 710 ACCESSORIES			
Part Number	9.1717.23		REFLECTOR ASSEMBLY - SCREW MOUNT
	9.1717.52 (12 Volt)	9.1720.52 (24 Volt)	MOTOR/REFLECTOR ASSEMBLY - CLIP MOUNT
	9.1717.54 (12 Volt)	9.1720.54 (24 Volt)	MOTOR
	9.1737.91		TWO DRIVE BELTS
	1653		MAGNETIC MOUNTING KIT



P/N 9.1717.54/9.1720.54

P/N 9.1737.91

P/N 1653

P/N 9.1717.23
Screw mount

P/N 9.1717.52
Clip mount

KL JUNIOR PLUS ACCESSORIES		
Part Number	9.1797.91	DRIVE BELT



KL 8000 ACCESSORIES		
Part Number	9.1794.23	REFLECTOR ASSEMBLY
	9.1726.52	MOTOR ASSEMBLY 12/24V
	9.1737.91	TWO DRIVE BELTS



P/N 9.1726.52

P/N 9.1737.91



P/N 9.1794.23

ROTOFLEX AND ROTOFIX ACCESSORIES			
Part Number	9.1730.23		REFLECTOR FOR ROTOFLEX
	9.1732.23		REFLECTOR FOR ROTOFIX
	9.1732.52 (12 Volt)	9.1732.54 (24 Volt)	MOTOR



P/N 9.1732.52/9.1732.54



P/N 9.1730.23

P/N 9.1732.23