



LED Safety DayLights™

Safety DayLights™ are signal lamps that significantly enhance the visibility of your vehicle during daylight hours to prevent vehicle crashes by 'accidental oversight'.



Contents

LED Safety DayLights™

LED Safety DayLights™ Kit - Easy-Fit.....	78
LED Safety DayLights™ Kit - 15°	78
LED Safety DayLights™ Kit - 30°	79
LED Safety DayLights™ Kit - Rectangular	79
LED Safety DayLights™ Kit - Recess Mount	80
LED Safety DayLights™ - Compact Mount.....	80
LED Safety DayLights™ Kit - Surface Mount.....	81
LED Safety DayLights™ DuraLED®	81
LED Safety DayLights™ 83mm.....	82
Safety DayLights™ Smart Controller	83
Dual Function Safety DayLights™ Controller.....	83



HELLA LED SAFETY DAYLIGHTS™

BE SAFE BE SEEN

Failure to see another road user in time (or at all) is a contributing factor in over 50% of all daytime accidents. For daytime intersection accidents this increases to as much as 80%.

Source: The Safety Effects of Daytime Running Lights, SWOV, 1997

Why Install HELLA Safety DayLights™?

You might ask yourself "can't I just switch on my headlamps?", since the use of dipped beam headlamps during daylight hours has long been promoted as a Road Safety Initiative around the country.

Dipped beam headlamps are designed to effectively light up the road in front of the vehicle during darkness, whilst causing as little glare as possible to oncoming traffic.



Hence during daytime, dipped beam headlamps 'waste' most of their light directed to the road in front of the vehicle but provide very little as a signal to other road users in bright daylight. Using your Dipped Beam Headlamps during daylight hours has only a marginal added safety effect.

Safety DayLights™ on the other hand are designed to significantly enhance the conspicuity of your vehicle during daylight hours because precision optics direct all the light towards the other road users.

HELLA LED Safety DayLights™

Safety DayLights™ are forward facing signal lamps that significantly enhance the visibility of your vehicle during daylight hours to prevent vehicle crashes by 'accidental oversight'.

As road users we have all experienced the 'fright second' of a near miss by being overlooked by another car, van or truck.

Equally frightening is almost not noticing another vehicle approaching due to an inconspicuous vehicle colour, the low sun casting harsh shadows or sun strike.

Any single one of these 'fright seconds' has the potential to end in a tragic outcome and become a number in the road toll statistics.

Safety DayLights™ are a "never forget" safety enhancement. They automatically switch ON when the ignition is switched ON and automatically switch OFF when the headlamps are turned ON in order not to dazzle other road users at night.

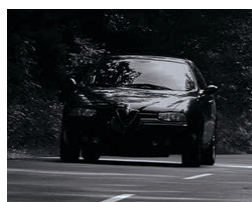

Headlamps Off

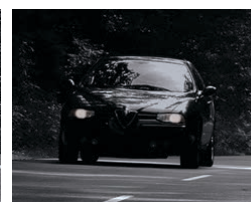

Low Beam Headlamps

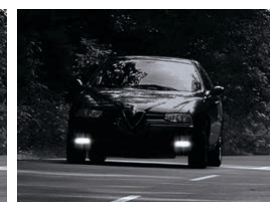

HELLA LED Safety DayLights™

Low Beam Headlamps

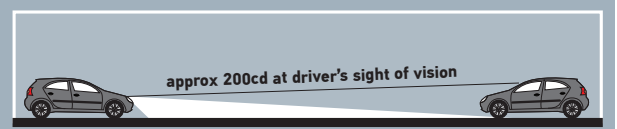

Designed to light the road at night without causing glare to other road users.

HELLA LED Safety DayLights™



Designed to increase the visibility (conspicuity) of your vehicle during daylight hours.



SETTING A STANDARD IN ROAD SAFETY

New Zealand's extensive roading network is used by millions of Kiwis every day. Statistically the risk of being harmed in a road accident is one of the highest severe injury risks we face every day.

Data from New Zealand's Ministry of Transport shows that thousands of crashes occur each year resulting in injury and fatalities. In 2012 there were 201 fatalities on our roads as well as 31,691 traffic related ACC claims.

The economic cost of road accidents to New Zealand has been calculated at some 3.14 Billion Dollars in 2011*, the majority occurring during daylight hours when visibility and conspicuity should be at its peak.

*source: Motor Vehicle Crashes in New Zealand. Ministry of Transport, 2011, 2012 / ACC Claims Statistic 2012.

Worldwide Studies

The effectiveness of Safety DayLights™ (DRLs) has been studied extensively worldwide and their mandatory use being adopted into legislation in most European countries.

Benefits of LED Safety DayLights™

- Low power consumption.
- Advanced UV resistant material.
- 5 year warranty.
- Approved for use in New Zealand and Australia.



P/N 5636 shown.

SAFETY DAYLIGHTS™ SMART CONTROLLER DESIGNED TO SIMPLIFY INSTALLATION

HELLA's Safety DayLights™ Smart Controller is designed to simplify the installation of Safety DayLights™ by eliminating the need to connect the lamp, or changeover relay, to ignition terminal 15. The vehicle's ignition feed is typically used as a signal to turn Safety DayLights™ ON. Correctly identifying terminal 15 (Ignition) in the engine bay can be a difficult task on some vehicles, requiring specialised tools and in some cases the only solution is to route the wiring back through the fire wall into the vehicle cabin. This procedure can greatly increase the time and cost it takes to install Safety DayLights™. It can also be a daunting experience for the DIY-er not familiar with the electronic complexity of the modern vehicle.

The Safety DayLights™ Smart Controller reduces the installation complexity as it is directly connected to the positive terminal of the battery where it will sense that the vehicle engine has been activated.

The Safety DayLights™ Smart Controller uses advanced electronics that constantly monitor the voltage of the battery and other tell tale signs that the engine has been started. It will automatically switch the Safety DayLights™ ON. It will deactivate the Safety DayLights™ when the headlamps are turned ON or the engine is turned OFF (after a small delay).

MINIMISING ENVIRONMENTAL IMPACT

HELLA LED Safety DayLights™ are a durable, environmentally-friendly investment into road safety.

Energy Efficiency

HELLA LED Safety DayLights™ use less than 5 watts per pair, equating to 95% less energy than the Dipped Headlamps of your vehicle.

Q: Why is a safer light using so much less energy?

A: LED Safety DayLights™ are designed to direct light at other road users and not onto the road in front of the vehicle as Dipped Beam Headlamps do.

Q: Will this save me petrol compared to using my headlamps?

A: Studies have shown that the average family car will save as much as 0.2 litres of petrol per 100km. For the entire New Zealand fleet this equates to a reduced environmental impact of over 100,000 tons per year of CO₂ emissions.

Q: What about my headlamp bulbs?

A: Using highly effective Safety DayLights™ instead of your Dipped Beam Headlamps, will of course also extend the life of your valuable headlamp bulbs.



Dipped Headlamps Versus High Efficacy LED Safety DayLights™

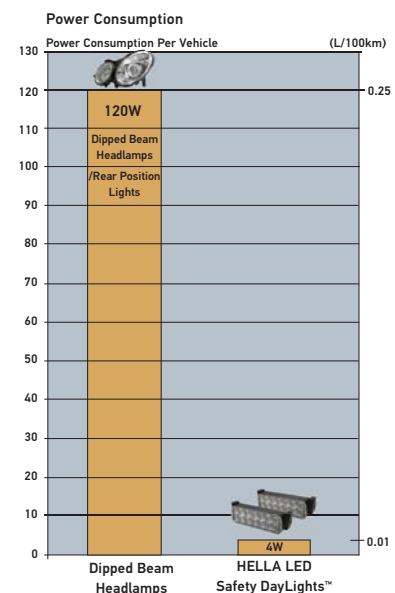

Power and Fuel Consumption and CO₂ Emissions

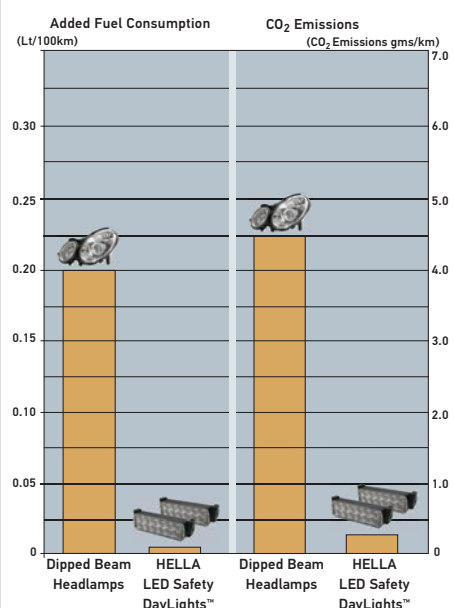

LED Safety DayLights™ Kit - Easy-Fit

Forward facing signal lamps, designed to be mounted on vehicles with flat fronts, or on motorbikes. The lamps are an Easy-Fit installation, usually requiring no extra parts. Once the wiring is complete and the bracket is fitted, the LED lamp easily clips into place and installation is complete.



P/N 5636-BL

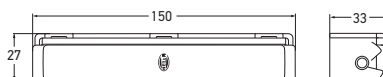

Part Number	5636	12 VOLT
	5636-BL (Blister pack)	
	5636-24V	24 VOLT
Mounting	Suitable for horizontal mounting.	
Power Consumption	2W	
Protection	Reverse polarity protection. IP 6K7 (Protection against dust and temporary water immersion) IP 6K9K (Protection against dust and high-pressure/steam jet cleaning)	
Cable Length	Pre-wired with 2.5m of sheathed multi-core cable.	
Spare Parts	1013 1013-24V	Single lamp 12V Single lamp 24V
Lens Material	High impact acrylic.	
Compliance	ADR 76/00 E24 5875 ECE R87/00	
Kit Contents	2 x LED Safety DayLights™ 2 x Mounting brackets 1 x Changeover relay 1 x Instruction sheet	

See page 83 for front position relay option.

LED Safety DayLights™ Kit - 15°

A lens angle of 15 degrees allows installation as close as possible to the corners of a modern motor vehicle. These lamps were designed to fit the curved bumpers of modern vehicles to give the look of Original Equipment fitment. The lamps have extremely low power consumption at 2W per lamp and high impact acrylic lenses to protect against impact damage.



P/N 5630-BL

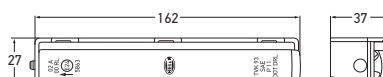

Part Number	5630	12 VOLT
	5630-BL (Blister pack)	
	5630-24V	24 VOLT
	5630-24VBL (Blister pack)	
Mounting	Suitable for horizontal mounting.	
Power Consumption	2W	
Protection	Reverse polarity protection. IP 6K7 (Protection against dust and temporary water immersion) IP 6K9K (Protection against dust and high-pressure/steam jet cleaning).	
Cable Length	Pre-wired with 2.5m of sheathed multi-core cable.	
Lens Material	High impact acrylic.	
Compliance	E24 5863 ECE R87/00	
Kit Contents	2 x LED Safety DayLights™ 2 x Mounting brackets 1 x Changeover relay 1 x Instruction sheet	

See page 83 for front position relay option.

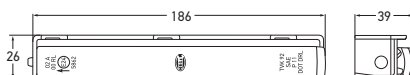

Part Number	5631	12 VOLT
	5631-BL (Blister pack)	
	5631-24V	24 VOLT
Mounting	Suitable for horizontal mounting.	
Power Consumption	2W	
Protection	Reverse polarity protection. IP 6K7 (Protection against dust and temporary water immersion) IP 6K9K (Protection against dust and high-pressure/steam jet cleaning).	
Cable Length	Pre-wired with 2.5m of sheathed multi-core cable.	
Lens Material	High impact acrylic.	
Compliance	E24 5862 ECE R87/00	
Kit Contents	2 x LED Safety DayLights™ 2 x Mounting brackets 1 x Changeover relay 1 x Instruction sheet	
See page 83 for front position relay option.		

LED Safety DayLights™ Kit - 30°

A lens angle of 30 degrees allows installation as close as possible to the corners of a modern motor vehicle. These lamps were designed to fit the curved bumpers of modern vehicles to give the look of Original Equipment fitment. The lamps have extremely low power consumption at 2W per lamp and high impact acrylic lenses to protect against impact damage.



P/N 5631-BL

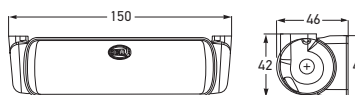

Part Number	5617		
	5617-OE		
Mounting	Suitable for horizontal mounting.		
Voltage	Multivolt™ for optimum brightness at input voltages from 9 to 33 volts.		
Power Consumption	<2W each		
Protection	Reverse polarity and transient spike circuit protection. IP 6K7 (Protection against dust and temporary water immersion) IP 6K9K (Protection against dust and high-pressure/steam jet cleaning)		
Spare Part	1004	Single lamp (with 0.5m of multi-core cable)	
Cable Length	5617	Pre-wired with 0.5m of multi-core cable.	
	5617-OE	Pre-wired with 2.5m of multi-core cable.	
Lens Material	Grilamid®		
Compliance	ADR 76/00	E24 0002	ECE R87/00
Kit Contents	P/N 5617 kit contains: 2 x LED Safety DayLights™ 1 x Professional wiring harness and super seal connectors 4 x Mounting brackets 1 x Instruction sheet		P/N 5617-OE kit contains: 2 x LED Safety DayLights™ with 2.5m sheathed multi-core cable. 4 x Mounting brackets 1 x Instruction sheet

LED Safety DayLights™ Kit
- Rectangular

Rectangular shaped ultra light lamps offering maximum visibility in road traffic during the day. Features lightweight housing, universal mounting bracket and ultra-durable Grilamid® nylon lens for extreme impact, UV and chemical resistance. Easy wiring requiring only 3 connections, earth (-), ignition (+) and position lamps (+).

P/N 5617
Wiring harness and
super seal connectors.

P/N 5617

P/N 5617-OE

LED Safety DayLights™ Kit - Recess Mount

Recess mount strip lamp, flush mounted for a professional finish. Features low power consumption, reverse polarity protection, and a durable Grilamid® lens to protect against impact damage.

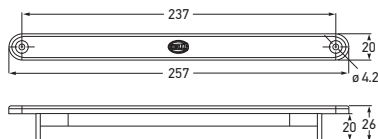

Part Number	5618	12 VOLT
	5618-24V	24 VOLT
Mounting	Two hole recess mount. Suitable for horizontal mounting.	
Power Consumption	2W	
Protection	Reverse polarity protection. IP 6K7 (Protection against dust and temporary water immersion) IP 6K9K (Protection against dust and high-pressure/steam jet cleaning)	
Cable Length	Pre-wired with 2.5m of multi-core cable.	
Spare Parts	1005 Single lamp 12V 1005-24V Single lamp 24V	
Lens Material	Grilamid®	
Compliance	(E24) 0001 ECE R87/00	
Kit Contents	2 x LED Safety DayLights™ 1 x Changeover relay 1 x Instruction sheet	

LED Safety DayLights™ - Compact Mount



Strip lamp which clips into a separate mounting bracket for ease of installation. This lamp is ECE certified and is supplied with a mounting bracket and screws. The lens is made of durable Grilamid® to protect against impact damage, and the lamps feature reverse polarity protection.

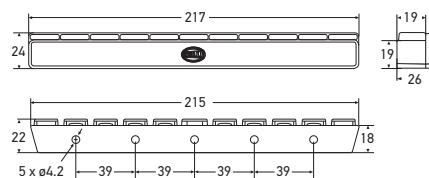

Mounting bracket

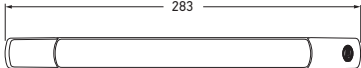

Part Number	1008	12 VOLT
	1008-24V	24 VOLT
Mounting	Suitable for horizontal mounting.	
Power Consumption	2W	
Protection	Reverse polarity protection. IP 6K7 (Protection against dust and temporary water immersion) IP 6K9K (Protection against dust and high-pressure/steam jet cleaning)	
Cable Length	Pre-wired with 2.5m of sheathed multi-core cable.	
Lens Material	Grilamid®	
Compliance	(E24) 0001 ECE R87/00	

<div><div><div>Compliance</div><div>ADR COMPLIANCE</div></div><div><div>Lens Material</div><div>GMD</div></div></div> <div><div>Mounted perpendicular to the vehicle axis</div><div></div></div>		<div><div></div><div></div></div>	
Part Number	5619 (Horizontal mount)	12 VOLT	
	5619-24V (Horizontal mount)	24 VOLT	
	5619V (Vertical mount)	12 VOLT	
	5619V-24V (Vertical mount)	24 VOLT	
Power Consumption	3W		
Protection	Reverse polarity protection. IP 6K7 (Protection against dust and temporary water immersion) IP 6K9K (Protection against dust and high-pressure/steam jet cleaning)		
Cable Length	Pre-wired with 2.5m of sheathed multi-core cable.		
Spare Parts	1009 1009-24V 1009V 1009V-24V 9.2652.09 9.1009.09	Single lamp 12V (Horizontal mount) Single lamp 24V (Horizontal mount) Single lamp 12V (Vertical mount) Single lamp 24V (Vertical mount) White screw caps (Pack of 4) Charcoal screw caps (Pack of 4)	
Lens Material	Grilamid®		
Compliance	ADR 76/00	 5869	ECE R87/00
Kit Contents	2 x LED Safety DayLights™ 4 x Mounting screws 4 x Screw caps 1 x Changeover relay 1 x Instruction sheet		
See page 83 for front position relay option.			

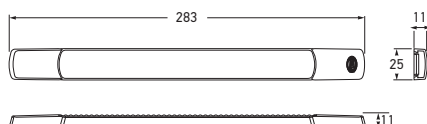

LED Safety DayLights™ Kit - Surface Mount

Surface mount LED Safety DayLights™ designed to fit flat-fronted vehicles. Comes either as a single lamp, or as a kit. The lamp is ADR compliant and features a Grilamid® lens to protect against impact damage.

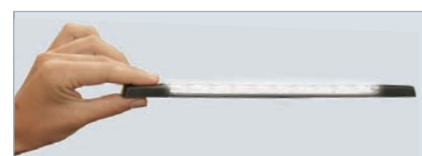

Ultra slim height of only 11mm. Lamp shown active.

Part Number	1003
	Mounting
	Two hole recess mount with mounting bushes supplied. Suitable for horizontal mounting.
	Voltage
	Multivolt™ for optimum brightness at input voltage from 9 to 33 volts.
Power Consumption	3W
Protection	Reverse polarity and transient spike circuit protection. IP 6K6 (Protection against dust and high-pressure water jets) IP 6K7 (Protection against dust and temporary water immersion)
Cable Length	Pre-wired with 2.5m of sheathed multi-core cable.
Lens Material	Grilamid®
Compliance	ADR 76/00
See page 66 for DuraLED® accessories.	

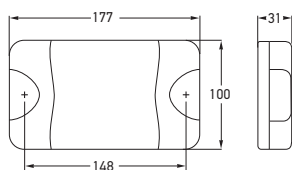

DuraLED® Safety DayLights™

LED DuraLED® Safety DayLights™ for trucks, commercial vehicles and buses.



83mm Round LED Safety DayLights™

This LED lamp features an integrated Safety DayLight™ and front position function. The lamp features a traditional round lens that illuminates with a distinctive ring of white LEDs when used as a Safety DayLight™.

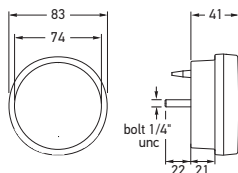

83MM LAMP FUNCTIONS



LED Safety DayLights™

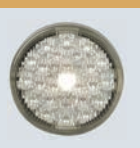

Front position (P/N 1007-24V only)

Part Number	1006	12 VOLT
	1007-24V (Includes front position lamp)	24 VOLT
Mounting	Flush mount. Single bolt 1/4" stainless UNC thread. Nut and washer supplied.	
Power Consumption	Safety DayLights™: 4W Front position: 1W (P/N 1007-24V only)	
Protection	Reverse polarity and transient spike circuit protection. IP 6K7 (Protection against dust and temporary water immersion) IP 6K9K (Protection against dust and high-pressure/steam jet cleaning)	
Cable Length	Pre-wired with 2.5m of sheathed multi-core cable.	
Lens Material	Grilamid®	
Compliance	E24 5854	ECE R87/00 ECE R7/02 (1007-24V)

See page 69 for mounting accessories.

83mm Round LED Safety DayLights™/Front Position/ Front Direction Indicator Lamp

This LED combination lamp features an integrated Safety DayLight™, front position and front direction indicator function. The lamp features a traditional round lens that illuminates with a distinctive ring of white LEDs when used as a Safety DayLight™. This lamp eliminates the need for installation of multiple lamps.

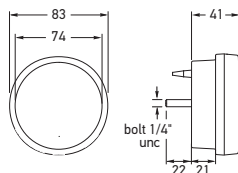

83MM LAMP FUNCTIONS



LED Safety DayLights™



Front position



Front direction indicator

Part Number	2108-GMD	12 VOLT												
	2108-GMD24V	24 VOLT												
Mounting	Flush mount. Single bolt 1/4" stainless UNC thread. Nut and washer supplied.													
Power Consumption	<table border="1"> <thead> <tr> <th></th><th>P/N 2108-GMD</th><th>P/N 2108-GMD24V</th></tr> </thead> <tbody> <tr> <td>Safety DayLights™:</td><td>3W</td><td>4W</td></tr> <tr> <td>Front position:</td><td>1W</td><td>1W</td></tr> <tr> <td>Front indicator:</td><td>4W</td><td>4W</td></tr> </tbody> </table>			P/N 2108-GMD	P/N 2108-GMD24V	Safety DayLights™:	3W	4W	Front position:	1W	1W	Front indicator:	4W	4W
	P/N 2108-GMD	P/N 2108-GMD24V												
Safety DayLights™:	3W	4W												
Front position:	1W	1W												
Front indicator:	4W	4W												
Protection	Reverse polarity and transient spike circuit protection. IP 6K7 (Protection against dust and temporary water immersion) IP 6K9K (Protection against dust and high-pressure/steam jet cleaning)													
Cable Length	Pre-wired with 2.5m of sheathed multi-core cable.													
Lens Material	Grilamid®													
Compliance	ADR 6/00: Cat 1a ECE R6/01	ADR 49/00 ECE R7/02 ADR 76/00 ECE R87/00 E24 5854												

See page 69 for mounting accessories.

LED SAFETY DAYLIGHTS™

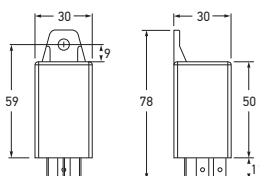

Part Number	3090
Voltage	Multivolt™, suitable for 12 and 24 volt systems.
Maximum Continuous Load	20W
To Suit	HELLA LED Safety DayLights™ range.
Features a Safety DayLights™ OFF delay of approximately 10 seconds.	

RECOMMENDED INSTALLATION DIAGRAM FOR WIRING

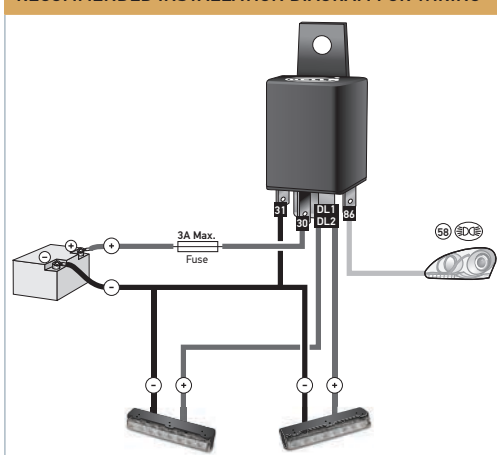

WIRING SPECIFICATIONS

Terminal Number	Connect to
30	Battery (+)
31	Earth return (-)
86	Front position or headlamps (+)
DL1 & DL2	Safety DayLights™ (+)

Safety DayLights™ Smart Controller

This smart controller is designed to simplify the installation of HELLA's LED Safety DayLights™ range by eliminating the need to wire the lamp, or changeover relay to ignition terminal 15.

The Safety DayLights™ Smart Controller can be wired directly to the positive terminal of the battery, which saves the difficult and often time consuming task of finding the ignition feed. The smart controller monitors the voltage supply from the battery and will automatically switch the Safety DayLights™ ON when the engine is started, and automatically switch them OFF when the headlamps are activated, or the engine is turned OFF.

Safety DayLights™ Smart Controller may not function on hybrid vehicles or vehicles with stop/start systems.



Dual Function Safety DayLights™ Controller

This controller is designed to turn your HELLA Safety DayLights™ into front position lamps at night. The dual function controller is connected and activated by the headlamp of the vehicle.

The dual function controller reduces the current to the Safety DayLights™ thus turning them into road legal* front position lamps. Only one controller is required for a pair of HELLA Safety DayLights™.

* Please note legally required spacing of front position lamps and only one pair of front position lamps is legally permitted.

Part Number	9.5630.03	12 VOLT
	9.5636.03	
	9.5630.04	
	9.5636.04	24 VOLT
To Suit	P/N 9.5630.03 P/N 9.5636.03 P/N 9.5630.04 P/N 9.5636.04	P/Ns 1009, 5619, 5630, 5631 P/N 5636 P/Ns 1009-24V, 5619-24V, 5630-24V, 5631-24V P/N 5636-24V

RECOMMENDED INSTALLATION DIAGRAM FOR WIRING

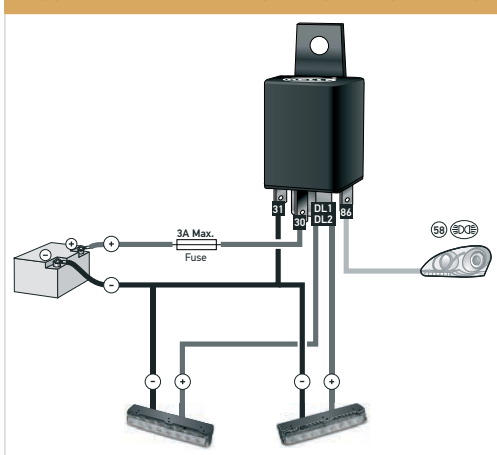

WIRING SPECIFICATIONS

Terminal Number	Connect to
30	Ignition (+)
85	Earth return (-)
86	Front position or headlamps (+)
87A	Safety DayLights™ (+)

