



Headlamps and Inserts

Hella has manufactured headlamp systems for more than 100 years. The durability and reliability of Hella products has made Hella a world leader in headlamp technology.





Headlamps and Inserts

<i>Daytime Running Lamp – BMW 3 Series</i>	58
<i>BMW 3, 5 Series and Mercedes-Benz W211 Headlamps</i>	59
<i>BMW 5 Series Headlamps and Rear Lamps</i>	60
<i>BMW 3, 5 and 7 Series Headlamps</i>	61
<i>VW Golf MK III-MK IV</i>	62
<i>Universal Headlamps</i>	63
<i>90mm Universal Headlamps</i>	64-65
<i>Semi Sealed Headlamps and Housings - Rectangular</i>	66
<i>Semi Sealed Headlamps - 5 ¾" Round</i>	67
<i>Semi Sealed Headlamps and Housings - 7" Round</i>	68
<i>Bulb Connectors</i>	69
<i>5 ¾" Conventional Sealed Beams</i>	70
<i>4 ½" Conventional Sealed Beams</i>	71



***SAFETY through
Vision and Innovation***



1000

Daytime Running Lamp



DESCRIPTION	Clear lens lamp with steel bracket. Small size for easy fitment.	
MOUNTING	Pendant or upright.	
BULBS TO SUIT	12V	R1221
	24V	R2421, R2421-TS
SPARE PART	9.1000.01	White lens
COMPLIANCE	E1 700 8701	

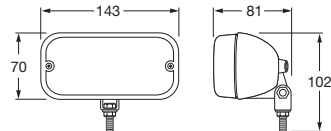

3-Series (E36) Compact 04/94 - 08/00

1LJ 007 143-051

Headlamp (HB3/HB4) with Electric Leveller - LH



1LJ 007 143-061

Headlamp (HB3/HB4) with Electric Leveller - RH



BULBS TO SUIT	Dipped beam:	CC1255
	Main beam:	CB1265
	Position:	W125
SPARE PARTS	9ES 145 251-005	Cover lens LH
	9ES 145 252-005	Cover lens RH
COMPLIANCE	LH	E1 80
	RH	E1 81



3-Series (E36) 04/94 - 08/00

1AL 007 045-011

Headlamp H1 - LH



1AL 007 045-021

Headlamp H1 - RH



BULBS TO SUIT	Headlamp:	C1255 x 2
	Position:	W125
COMPLIANCE	E1 8026	



3-Series (E36) 12/90 - 08/00

1NB 006 270-051

Fog Lamp H1 - LH



1NB 006 270-061

Fog Lamp H1 - RH



BULB TO SUIT	C1255
COMPLIANCE	E1 18236

3-Series (E46) 10/01 - 09/05

1LG 009 059-031	Headlamp H7 - LH	
1LG 009 059-041	Headlamp H7 - RH	

BULBS TO SUIT Headlamp: CA1255 x 2 (H7)
 Position: W125
COMPLIANCE



3-Series (E46) 02/98 - 09/01

1ND 007 646-011	Fog Lamp HB4 - LH	
1ND 007 646-021	Fog Lamp HB4 - RH	

BULB TO SUIT CC1255
COMPLIANCE



5-Series (E60) 07/03 - 12/07

1LL 160 695-001	Headlamp (Bi-Xenon®) - LH	
1LL 160 696-001	Headlamp (Bi-Xenon®) - RH	

DESCRIPTION BMW 5-Series E60/E61 headlamp featuring Bi-Xenon® and Celis technology.

BULBS TO SUIT Dipped beam: D2S
 Main beam: CA1255
 Indicator: RY1221

COMPLIANCE



2SK 008 679-811 Upgrade Rear Combination Lamp Set

DESCRIPTION Clear lens style tail lamps. Includes two tail lamp assemblies with instructions.

COMPLIANCE



W211 E200 - E500 Mercedes-Benz 03/02

1LL 008 369-271	Headlamp (Bi-Xenon®/H7) - LH	
1LL 008 369-281	Headlamp (Bi-Xenon®/H7) - RH	

DESCRIPTION Headlamp with indicator lamp, electronic headlamp leveller actuator, Xenon ballast, gas discharge bulb and pre-fitted 12V bulbs.

BULBS TO SUIT Dipped beam: D2S
 Main beam: CA1255
 Indicator: RY1221
 Position: W125

COMPLIANCE





5-Series (E39) Saloon 09/00 - 06/03

12V Bulb Incl.

1LL 008 053-591

Headlamp (H7/H7) with Electric Leveller - LH



12V Bulb Incl.

1LL 008 053-601

Headlamp (H7/H7) with Electric Leveller - RH



BULBS TO SUIT Headlamp: CA1255 x 2
Indicator: RY1221
Position: YL1210

COMPLIANCE E1 1182



8KB 157 198-801

Headlamp Adaptor Lead Set

DESCRIPTION To adapt headlamps P/N's 1LL 008 053-591/-601 to E39 from 12/95 to 09/00. One set required per car.



5-Series (E39) 12/95 - 08/00

1NA 009 026-011

Fog Lamp (H7) - LH



1NA 009 026-021

Fog Lamp (H7) - RH



DESCRIPTION Front fog lamps with H7 bulbs and Free-Form (FF) reflector.

BULB TO SUIT CA1255

COMPLIANCE E12 19094

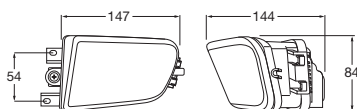

12V Bulb Incl.

2VP 008 272-861

Upgrade Combination Rear Lamp Set



DESCRIPTION Innovative combination rear lamp with a brilliant appearance using the Celis light guide technology for the tail light function. The position light is produced by 8 red LEDs arranged in horizontal light guide strips.

BULBS TO SUIT Stop: R1221
Indicator: RY1221

COMPLIANCE E1 1070 E1 1071

5-Series (E34) 09/88 - 03/97 and 7-Series (E32) 09/88 - 05/94		
9BG 135 927-011	Dipped Beam Lens - LH	
9BG 135 928-011	Dipped Beam Lens - RH	
1K3 132 253-011	Main Beam (H1) - LH	
1K3 132 266-011	Main Beam (H1) - RH	

BULB TO SUIT C1255
COMPLIANCE Dipped beam: 7407
 Main beam: 34572



Dipped beam

Main beam

5-Series (E34) 01/89 - 03/97		
1NL 005 680-111	Fog Lamp (H1) - LH	
1NL 005 680-121	Fog Lamp (H1) - RH	

BULB TO SUIT C1255
COMPLIANCE 18215 18222



3-Series (E30) 01/83 - 08/87		
1K3 126 046-001	Main Beam (H1) - LH	
1K3 126 680-001	Main Beam (H1) - RH	

BULB TO SUIT C1255
COMPLIANCE 14464



3-Series (E30) 09/88 - 03/97		
9BG 135 941-011	Dipped Beam Lens - LH	
9BG 135 942-011	Dipped Beam Lens - RH	
1K3 134 855-011	Main Beam (H1) - LH	
1K3 134 856-011	Main Beam (H1) - RH	

BULB TO SUIT C1255
COMPLIANCE Dipped beam: 7407
 Main beam: 34572



Dipped beam

Main beam



1LJ 009 292-821

Upgrade Headlamp Golf IV Kit (8/97 - 6/04)



DESCRIPTION

Clear glass design with chrome plated covers. Bulbs included.

BULBS TO SUIT

Headlamp: CA1255 x 2
Indicator: RQ1221
Position: W125

COMPLIANCE

LH: (E1) 27001
(E1) 44468

RH: (E1) 27002
(E1) 44469



1LJ 006 360-671

Headlamp VW Golf III - LH (11/91 - 8/97)



1LJ 006 360-681

Headlamp VW Golf III - RH (11/91 - 8/97)



DESCRIPTION

Headlamp for vehicles with or without headlamp leveller.

BULBS TO SUIT

Headlamp: CA1255 x 2
Position: W125

COMPLIANCE

LH (E1) 27001
(E1) 44468

RH (E1) 27002
(E1) 44469



1LJ 007 235-251

Headlamp VW Golf III - LH (11/91 - 8/97)



1LJ 007 235-261

Headlamp VW Golf III - RH (11/91 - 8/97)



DESCRIPTION

Headlamp for use with H4 bulb.

BULBS TO SUIT

Headlamp: XD1260/55
Position: W125

COMPLIANCE

LH (E1) 17191
RH (E1) 17192



1LJ 008 758-011

Headlamp VW Golf III - LH (11/91 - 8/97)



1LJ 008 758-021

Headlamp VW Golf III - RH (11/91 - 8/97)



DESCRIPTION

Headlamp with clear cover lens.

BULBS TO SUIT

Headlamp: CA1255 x 2
Indicator: RY1221
Position: W125

COMPLIANCE

LH (E1) 27001
RH (E1) 44468

1001 *Headlamp/Front Direction Indicator/
Front Position Lamp*



DESCRIPTION	Housing made of black impact and chemical resistant material. Suitable for 146mm (5 3/4") H4 headlamp inserts.	
MOUNTING	Horizontal and vertical mounting.	
BULBS TO SUIT	12V	24V
Dipped/Main beam:	XD1260/55	XD2475/70
Indicator:	R1221	R2421
Position:	HL124	HL244
SPARE PARTS	1055	Headlamp insert
9.1001.01		Lens - Indicator
COMPLIANCE	Headlamp:	E12 20006
	Indicator:	E12 7122

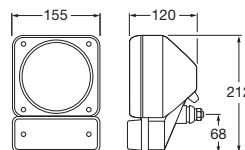

1LA 993 975-031 *Headlamp (H7/H3) LH - 12 Volt*



1LA 993 975-041 *Headlamp (H7/H3) RH - 12 Volt*



1LA 993 975-071 *Headlamp (H7/H3) LH - 24 Volt*



1LA 993 975-081 *Headlamp (H7/H3) RH - 24 Volt*



DESCRIPTION	Black glass-fibre reinforced lens-retaining rim with extended edge to protect lens. Universal bracket with M12 fixing screws.	
BULBS TO SUIT	12V	24V
Dipped beam:	CA1255	CA2470
Main beam:	YC1255	YC2470
Indicator:	R1221	R2421
Position:	HL124	HL244
PROTECTION	IP X9K (Protection against high pressure steam/jet cleaning)	
SPARE PARTS	1LA 990 185-011	Light unit
	9EL 990 186-001	Lens for indicator lamp, front
	9EL 990 186-101	Lens for indicator lamp, rear
ACCESSORIES	8JD 008 151-051	Socket for AMP plug connector
COMPLIANCE	E4 9496	

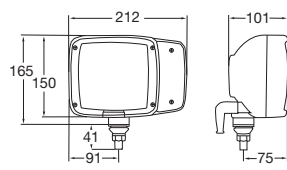

1018 *Headlamp Dipped Beam - LH*

1019 *Headlamp Dipped Beam - RH*

DESCRIPTION Light unit dimensions 190 x 132mm.
MOUNTING Complete with mounting frame.

BULBS TO SUIT	12V	24V
Headlamp:	C1255	C2470
Position:	HL124	HL244

COMPLIANCE E1 7414

Note Not suitable for 100W bulbs.

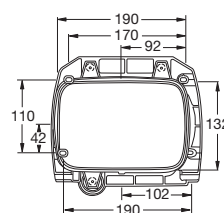

1020 *Headlamp Main Beam - LH*

1021 *Headlamp Main Beam - RH*

DESCRIPTION Light unit dimensions 190 x 132mm. For use in conjunction with low beam assemblies. P/N 1018 and 1019.

MOUNTING	Complete with mounting frame.	
BULBS TO SUIT	12V	24V
Main beam:	C1255	C2470

COMPLIANCE E1 44408 E1 34517





1029-24V



1030-24V

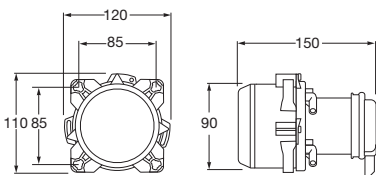

1029-24V



1029-24V

H7 Dipped Beam Headlamp - 24 Volt



1030-24V

H7 Main Beam Headlamp - 24 Volt



DESCRIPTION

Compact H7 headlamps with glass lens for buses, coaches and mobile homes. Includes headlamp adjusters.

BULBS TO SUIT

	12V	24V
Dipped/Main beam:	CA1255	CA2470
Position:	HL124	HL244

SPARE PARTS

9GH 152 654-007	Rear cap for 1029-24V and 1030-24V
9.1029.07	Rubber protective cap
9.1029.08	Position lamp connector set
9.1029.09	Mounting frame for 90mm headlamps

COMPLIANCE

Dipped beam:	E1 917
Main beam:	E1 917



9.1029.08



9.1029.07



9.1029.09

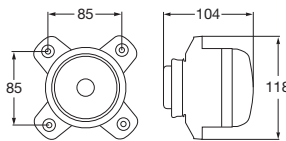

1030-24V

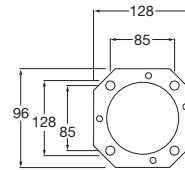

9.1029.09



1029H1-24V



1030H1-24V



1029H1-24V

H1 Dipped Beam Headlamp - 24 Volt



1030H1-24V

H1 Main Beam Headlamp - 24 Volt



DESCRIPTION

H1 headlamps with die cast aluminium reflector and hardened glass lens.

BULBS TO SUIT

	12V	24V
Dipped/Main beam:	C1255	C2455
Position:	HL124	HL244

SPARE PARTS

9.1029.10	Mounting frame for 90mm headlamps
-----------	-----------------------------------

COMPLIANCE

Dipped beam:	E1 2397
Main beam:	E1 2397

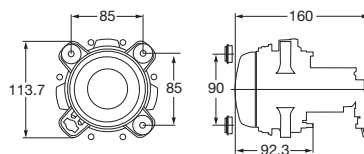

1029H1-24V

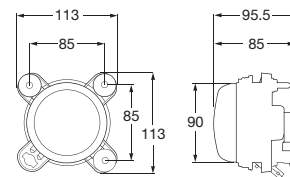

1030H1-24V

1LL 008 934-011 Bi-Xenon® Headlamp - 12 Volt



HID

1LL 008 934-031 Bi-Xenon® Headlamp - 24 Volt



HID

DESCRIPTION Xenon dipped beam and main beam are integrated into one headlamp with an electronic ballast. Module headlamps with integrated igniter and optically neutral glass cover lens. High quality metal reflector. Waterproof, 4th generation Xenon electronic ballast. 1m shielded supply cable with separate plug connections.

MOUNTING Mounting hardware included.

BULB TO SUIT D2S

SPARE PARTS 8JD 162 211 801 Main/dipped beam plug
9.1549.05 Deutsch plug and 2.5m sheathed cable for HID power pack

COMPLIANCE 1678

Note For Xenon dipped beam lamps to be ECE compliant they must be equipped with lens cleaning devices.

Please contact Hella for system options available.

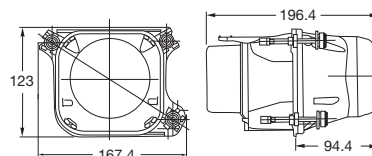

1LL 009 998-011 Bi-Halogen Headlamp - 12 Volt



1LL 009 998-051 Bi-Halogen Headlamp - 24 Volt



DESCRIPTION Compact H7 dipped/main beam headlamp. Pattern-free hardened glass lens and Free-Form (FF) cast aluminium reflector. Excellent light output and extremely homogeneous illumination with virtually no scatter. Straightforward installation with 3 pre-mounted adjustment screws on the vehicle body.

BULB TO SUIT 12V CA1255
24V CA2470

SPARE PARTS 9.1029.10 Mounting frame
9.1534.05 Bulb connector

COMPLIANCE 2484

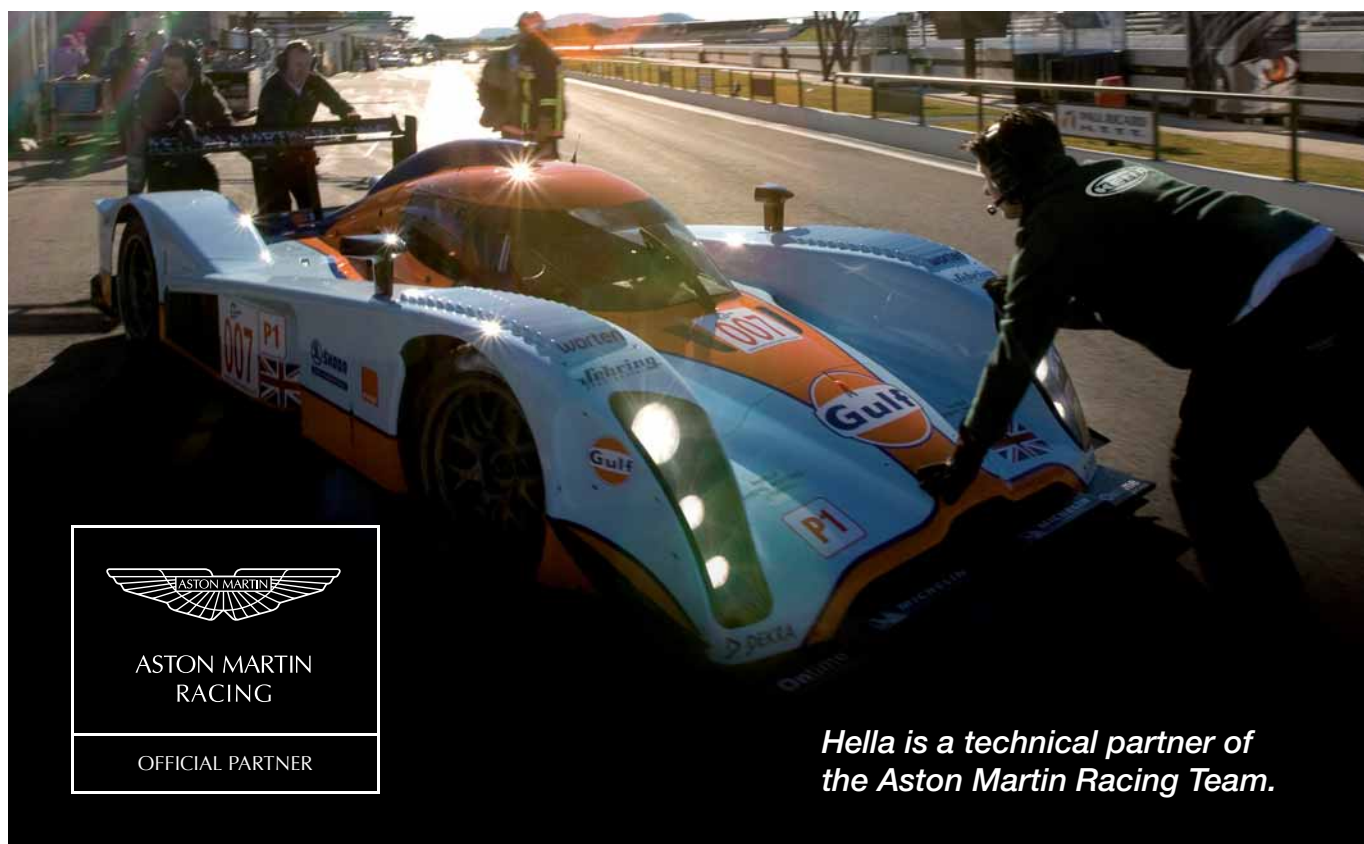

Hella is a technical partner of the Aston Martin Racing Team.



1043

200 x 142mm H4 Halogen High/Low Beam Insert



DESCRIPTION Semi-sealed headlamp with front position lamp bulb holder (includes P/N HL124 bulb).

BULBS TO SUIT

	12V	24V
Headlamp:	XD1260/55	XD2475/70
Front position:	HL124	HL244

SPARE PART
13839700 Front position bulb holder
9GH 126 647-011 Sealing boot

COMPLIANCE (E1) 17009 (E1) 17119



Sealing boot



1024

Rectangular Headlamp Housing

DESCRIPTION Suits 200 x 142mm rectangular headlamp units (P/N 1043). Ideal for truck, bus or body builders.

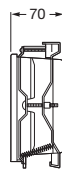
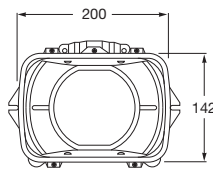

1041

165 x 100mm H1 Halogen High Beam Insert



DESCRIPTION Semi-sealed headlamp with sealing cap.

BULBS TO SUIT

	12V	24V
Headlamp:	C1255	C2470

COMPLIANCE (E1) 24504



1042

165 x 100mm H4 Halogen High/Low Beam Insert



DESCRIPTION Semi-sealed headlamp with sealing boot and wiring adaptor.

BULBS TO SUIT

	12V	24V
Headlamp:	XD1260/55	XD2475/70

SPARE PART
9GH 126 647-011 Sealing boot

COMPLIANCE (E1) 7197



Sealing boot



1044

165 x 100mm H4 Halogen High/Low Beam Insert



DESCRIPTION Semi-sealed headlamp with sealing boot and wiring adaptor.

BULBS TO SUIT

	12V	24V
Headlamp:	XD1260/55	XD2475/70
Front position:	HL124	HL244

SPARE PART
9FF 126 444-001 Bulb holder

COMPLIANCE (E1) 7197



1025

Twin Rectangular Headlamp Housing

DESCRIPTION For most 165 x 100mm rectangular headlamp units. Chrome plated outer rim. Complete with adjusting mechanisms for vertical/horizontal alignment and wiring loom. Ideal for truck, bus or body builders.

SPARE PART
9.1025.07 Chrome plated outer rim

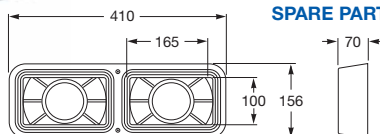

1040 146mm H1 Halogen Long Range Driving Insert

DESCRIPTION Semi-sealed headlamp, for high beam section of dual headlamp systems and sealing boot.

BULBS TO SUIT

	12V	24V
Headlamp:	C1255	C2470

SPARE PART 9GH 113 763-001 Sealing boot



1053 146mm H1 Halogen High Beam Insert ADR COMPLIANCE

DESCRIPTION Semi-sealed headlamp, for high beam section of dual headlamp systems and sealing boot.

BULBS TO SUIT

	12V	24V
Headlamp:	C1255	C2470

SPARE PART 9GH 113 763-001 Sealing boot

COMPLIANCE (E1) 14464

Note Earth terminal is a 'Post' (bullet) type connection.



1055 146mm H4 Halogen High/Low Beam Insert ADR COMPLIANCE

DESCRIPTION Semi-sealed headlamp with front position lamp bulb holder (includes P/N HL 124 bulb) and sealing boot. To suit headlamp systems.

BULBS TO SUIT

	12V	24V
Headlamp:	XD1260/55	XD2475/70
Front position:	HL124	HL244

SPARE PART 13839700 Front position bulb holder
9GH 126 647-011 Sealing boot

COMPLIANCE (E1) 17031



1055HD 146mm H4 Halogen High/Low Beam Insert - Hardened Glass ADR COMPLIANCE

DESCRIPTION High performance Halogen headlamp inserts fitted with extremely robust hardened glass lenses, providing maximum resistance when subjected to high operating temperatures and thermal shock. Ideal for 24 volt and high wattage bulb applications. Supplied complete with sealing boot and front position lamp bulb holder assembly.

BULBS TO SUIT

	12V	24V
Headlamp:	XD1260/55	XD2475/70
Front position:	HL124	HL244

COMPLIANCE (E1) 17031

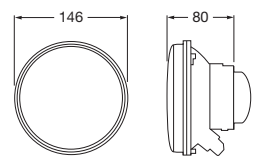

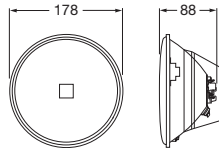

1056

178mm H4 Halogen High/Low Beam Insert



DESCRIPTION	Semi-sealed headlamp with sealing cap.	
BULBS TO SUIT	12V	24V
	Headlamp:	XD1260/55 XD2475/70
COMPLIANCE	E4 53	

Note Where front position lamp is required, use P/N. 1058.



1058

178mm H4 Halogen High/Low Beam Insert



DESCRIPTION	Semi-sealed headlamp with front position lamp bulb holder (includes P/N HL124 bulb) and sealing boot.	
BULBS TO SUIT	12V	24V
	Headlamp:	XD1260/55 XD2475/70
	Front position:	HL124 HL244
COMPLIANCE	E4 53	



1058HD

178mm H4 Halogen High/Low Beam Insert - Hardened Glass



DESCRIPTION	High performance Halogen headlamp inserts fitted with extremely robust hardened glass lenses providing maximum resistance when subjected to high operating temperatures and thermal shock. Ideal for 24 volt and high wattage bulb applications. Supplied complete with sealing boot and front position lamp bulb holder assembly.	
BULBS TO SUIT	12V	24V
	Headlamp:	XD1260/55 XD2475/70
	Front position:	HL124 HL244
COMPLIANCE	E4 53	

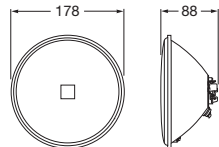

9.1358.01

178mm Halogen Driving Lamp Insert



DESCRIPTION	Suitable for use as high beam headlamp in most 178mm round headlamp carriers (eg. Part No. 1016).	
BULBS TO SUIT	12V	YC1255
	24V	YC2470
COMPLIANCE	E1 14529	

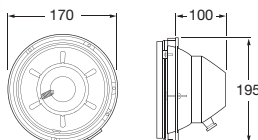

1016

178mm Headlamp Assembly

DESCRIPTION	For Halogen or conventional sealed beams and inserts 178mm diameter. Fully sealed steel cowl, complete with adjusting mechanism for vertical and horizontal alignment, sealing gasket, stainless steel retaining rim and 3 pin wiring harness with separate park lamp connection. Ideal for truck, bus or body builders. Suits Mercedes, Kenworth, Mack, White etc.
--------------------	---

1017

178mm Chrome Rim

DESCRIPTION	Outer chrome rim to suit P/N 1016.
--------------------	------------------------------------

1027 *H4 Halogen High/Low Beam Headlamp Assembly*



DESCRIPTION Lamp unit, lens dimensions 352 x 195mm, complete with mounting frame and adjusting mechanisms for vertical and horizontal alignment. Fully enclosed housing with removable rear sealing cap for bulb replacement access. Ideal for truck, bus or body builders.

MOUNTING Simple four point mounting.

BULBS TO SUIT

Headlamp:	12V	24V
Position:	XD1260/55	XD2475/70
	HL124	HL244

SPARE PARTS

9.1027.01	Clear lens
9.1027.02	Reflector
9.1027.04	Sealing cap

COMPLIANCE E1 17016

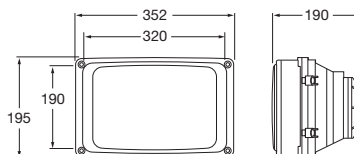

Bulb Connector

4972-H4	<i>H4 Bulb Connector - 200mm leads</i>
4972-H1	<i>H1 Bulb Connector</i>
4972-H7	<i>H7 Bulb Connector</i>

DESCRIPTION Plug with pre-installed leads and crimp connectors (H1 and H7). Adapts to original wiring by crimp connector and heat shrink insulator, H4 version with 200mm leads (no connectors).

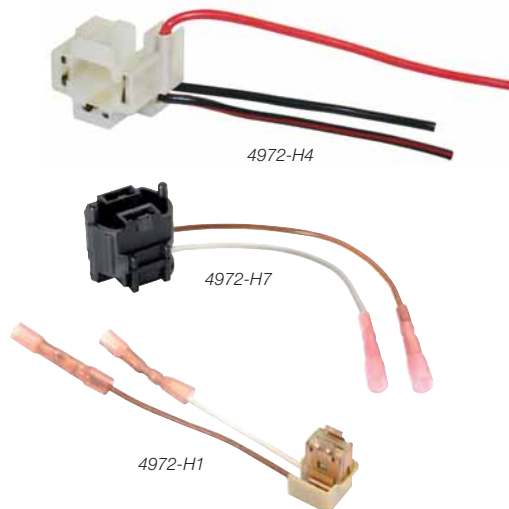

Sealed Beam Chart by Dimension

	Voltage/Wattage	Description	Trade No.		Voltage/Wattage	Description	Trade No.
146mm (5 3/4")				114mm (4 1/2")			
1078	12V-60W	Flood	4478	1082	12V-60W	Flood	4466
1080	24V-80/60W	High/low	4579-2	1084	12V-30W	Spot	4405
1094	12V-100W	Long range	4537-2	1085	12V-35W	Flood	4411
1096	24V-60W	Flood	4578	1086	12V-35W	Fog	4415
				1087	12V-30W	Spot	4416
				1089	12V-100W	Spot - long range	4509
				1092	24V-50W	Spot	4505
				1098	12V-40/40W	High/low	4440 X



1078



2 Contact Lugs

1078

146mm Flood Lamp Beam

TRADE PART NO. 4478
DESCRIPTION Flood lamp beam to suit construction and industrial machinery.
VOLTAGE 12V
POWER CONSUMPTION 60W



1080



3 Contact Lugs

1080

146mm High/Low Beam

TRADE PART NO. 4579-2
DESCRIPTION High/low beam to suit construction and industrial machinery.
VOLTAGE 24V
POWER CONSUMPTION Dipped beam: 60W
 Main beam: 80W

Note Not for road use as light pattern is for right-hand side traffic.



1094



2 Screw Terminals

1094

146mm Long Range Beam

TRADE PART NO. 4537-2
DESCRIPTION Search lamp/work lamp beam.
VOLTAGE 12V
POWER CONSUMPTION 100W



1096



2 Contact Lugs

1096

146mm Flood Lamp Beam

TRADE PART NO. 4578
DESCRIPTION Flood lamp beam to suit construction and industrial machinery.
VOLTAGE 24V
POWER CONSUMPTION 60W

1082 114mm Flood Lamp Beam

TRADE PART NO. 4466
DESCRIPTION Flood lamp beam to suit construction and industrial machinery.
VOLTAGE 12V
POWER CONSUMPTION 60W



2 Screw Terminals



1082

1084 114mm Spot Lamp Beam

TRADE PART NO. 4405
DESCRIPTION Spot lamp beam.
VOLTAGE 12V
POWER CONSUMPTION 30W



2 Screw Terminals



1084

1085 114mm Flood Lamp Beam

TRADE PART NO. 4411
DESCRIPTION Flood lamp beam to suit tractor applications.
VOLTAGE 12V
POWER CONSUMPTION 35W



2 Screw Terminals



1085

1086 114mm Fog Lamp Beam

TRADE PART NO. 4415
DESCRIPTION Fog lamp beam to suit automotive applications.
VOLTAGE 12V
POWER CONSUMPTION 35W



2 Screw Terminals



1086

1087 114mm Spot Lamp Beam

TRADE PART NO. 4416
DESCRIPTION Spot lamp beam to suit hand held spot lamp applications. P/N 1521.
VOLTAGE 12V
POWER CONSUMPTION 30W



2 Screw Terminals



1087

1089 114mm Spot Lamp/Long Range Beam

TRADE PART NO. 4509
DESCRIPTION Spot lamp beam to suit hand held spot lamp. P/N 1520.
VOLTAGE 12V
POWER CONSUMPTION 100W



2 Screw Terminals



1089

1092 114mm Spot Lamp Beam

TRADE PART NO. 4505
DESCRIPTION Spot lamp beam to suit hand held spot lamp. P/N 1525.
VOLTAGE 24V
POWER CONSUMPTION 50W



2 Screw Terminals



1092

1098 114mm High/Low Beam

TRADE PART NO. 4440X
DESCRIPTION High/low beam to suit tractor and automotive applications.
VOLTAGE 12V
POWER CONSUMPTION Dipped beam: 40W
 Main beam: 40W



3 Contact Lugs



1098